

NOTICE!!

These documents have been scanned!

Do not place un-scanned documents beneath this notice!

Do not remove this notice from this file!

GPO Jacket No. 560-102
Print Order 61540
Rise Business Services, LLC
Job=AZ15 7/3/2019



Box Number= AZ15143



Claim Begin-End: AMC350201-AMC350202

1 Initial Receipt



AZ15143-1 AMC350775-AMC351108

Lead MC 5-5-98

UNITED STATES
DEPARTMENT OF THE INTERIOR
BUREAU OF LAND MANAGEMENT

RECEIPT AND ACCOUNTING ADVICE

NO. 2388931

04

SM/AZ

05/04/98

Subject: LOCATION & SERVICE FEES (2) 2 20 11 25.00
CLAIM MAINTENANCE FEES 1998 (2) 2 20 12 10.00
Applicant: THOMAS J. SMALL 2 20 13 100.00

THOMAS J. SMALL
361 E. KANIKSU ST.
APACHE JUNCTION, AZ 85219

SAME - CK #1765
602-671-1053

Remitter:

JK
ENTERED IN COMPUTER

Assignor:

LEASE MANAGEMENT DATA NEW UPDATE PAYMENT

ORIGINAL SERIAL NO.	ASG.	TYPE	ST.	CTY.	FUND SYMBOL	ACRES/UNITS	RATE
AMC 350201-350202							

AMOUNT	ANV. DATE	EXP. DATE	BILL CYC.	S/C	DISTRICT	NEXT BILL	MISC. DATA	U of M	ACTUAL UNITS

ASSIGNMENT SERIAL NO.	ASG.	TYPE	ST.	CTY.	FUND SYMBOL	ACRES/UNITS	RATE

AMOUNT	ANV. DATE	EXP. DATE	BILL CYC.	S/C	DISTRICT	NEXT BILL	MISC. DATA	U of M	ACTUAL UNITS

APPLY REMITTANCE

ACTION	FUND SYMBOL	CTY.	AMOUNT
FILING FEE			
RENTAL			
UNEARNED			
REFUND			
TOTAL			
AMOUNT DUE			

Remarks:

BY:

DATE:

- Lease in Escrow?
- KGS?
- Auto Escalates?
- Auto Renew?

- Of Interest?
- Operating Rights?
- Operator
- Bond Filed?

FOR MMS USE ONLY

BILLEE	FOREST REFUGE
NUMBER	
OCS SECTION	
CODE	

Lead MC 5.5-95

UNITED STATES
DEPARTMENT OF THE INTERIOR
BUREAU OF LAND MANAGEMENT

RECEIPT AND ACCOUNTING ADVICE

NO. **2388931**
05/04/98

04

SM/AZ

Subject: LOCATION & SERVICE FEES (2) 2 20 11 25.00
CLAIM MAINTENANCE FEES 1998 (2) 2 20 12 10.00
Applicant: THOMAS J. SMALL 2 20 13 100.00

THOMAS J. SMALL
361 E. KANIKSU ST.
APACHE JUNCTION, AZ 85219

SAME - CK #1765
602-671-1053

Remitter:

ENTERED IN COMPUTER

Assignor:

LEASE MANAGEMENT DATA NEW UPDATE PAYMENT

ORIGINAL SERIAL NO.	ASG.	TYPE	ST.	CTY.	FUND SYMBOL	ACRES/UNITS	RATE
AMC 350201-350202							

AMOUNT	ANV. DATE	EXP. DATE	BILL CYC.	S/C	DISTRICT	NEXT BILL	MISC. DATA	U of M	ACTUAL UNITS

ASSIGNMENT SERIAL NO.	ASG.	TYPE	ST.	CTY.	FUND SYMBOL	ACRES/UNITS	RATE

AMOUNT	ANV. DATE	EXP. DATE	BILL CYC.	S/C	DISTRICT	NEXT BILL	MISC. DATA	U of M	ACTUAL UNITS

APPLY REMITTANCE

ACTION	FUND SYMBOL	CTY.	AMOUNT
FILING FEE			
RENTAL			
UNEARNED			
REFUND			
TOTAL			
AMOUNT DUE			

Remarks:

BY: _____ DATE: _____

Lease in Escrow?
 KGS? Of Interest?
 Auto Escalates? Operating Rights?
 Auto Renew? Operator
 Bond Filed?

FOR MMS USE ONLY

BILLEE NUMBER	FOREST REFUGE
OCS SECTION	
CODE	

UNITED STATES
DEPARTMENT OF THE INTERIOR
BUREAU OF LAND MANAGEMENT

Read MC 5.5-98

RECEIPT AND ACCOUNTING ADVICE

NO. 2388927

04

SM/AZ

05/04/98

Subject: LOCATION & SERVICE FEE (2) 2 1 11 25.00
CLAIM MAINTENANCE FEE 1998 (2) 2 1 12 10.00
Applicant: THOMAS J. SMALL 2 1 13 100.00
361 E. KANIKSU ST.
APACHE JUNCTION, AZ 85219

SAME - CK #1765
602-671-1053

Remitter:

Assignor:

LEASE MANAGEMENT DATA NEW UPDATE PAYMENT

ORIGINAL SERIAL NO.	ASG.	TYPE	ST.	CTY.	FUND SYMBOL	ACRES/UNITS	RATE
AMC 350201-350202							

AMOUNT	ANV. DATE	EXP. DATE	BILL CYC.	S/C	DISTRICT	NEXT BILL	MISC. DATA	U of M	ACTUAL UNITS

ASSIGNMENT SERIAL NO.	ASG.	TYPE	ST.	CTY.	FUND SYMBOL	ACRES/UNITS	RATE

AMOUNT	ANV. DATE	EXP. DATE	BILL CYC.	S/C	DISTRICT	NEXT BILL	MISC. DATA	U of M	ACTUAL UNITS

APPLY REMITTANCE			
ACTION	FUND SYMBOL	CTY.	AMOUNT
FILING FEE			
RENTAL			
UNEARNED			
REFUND			
TOTAL			
AMOUNT DUE			

Remarks:

BY: _____ DATE: _____

Lease in Escrow?
 KGS? Of Interest?
 Auto Escalates? Operating Rights?
 Auto Renew? Operator
 Bond Filed?

FOR MMS USE ONLY

BILLEE	FOREST REFUGE
NUMBER	
OCS SECTION	
CODE	

UNITED STATES
DEPARTMENT OF THE INTERIOR
BUREAU OF LAND MANAGEMENT

Read MC 5.5-98

RECEIPT AND ACCOUNTING ADVICE

NO. 2388927

SM/AZ

05/04/98

04

Subject: LOCATION & SERVICE FEE (2) 2 1 11 25.00
CLAIM MAINTENANCE FEE 1998 (2) 2 1 12 10.00
Applicant: THOMAS J. SMALL 2 1 13 100.00
361 E. KANIKSU ST.
APACHE JUNCTION, AZ 85219

SAME - CK #1765
602-671-1053

Remitter:

Assignor:

LEASE MANAGEMENT DATA NEW UPDATE PAYMENT

ORIGINAL SERIAL NO.	ASG.	TYPE	ST.	CTY.	FUND SYMBOL	ACRES/UNITS	RATE
AMC 350201-350202							

AMOUNT	ANV. DATE	EXP. DATE	BILL CYC.	S/C	DISTRICT	NEXT BILL	MISC. DATA	U of M	ACTUAL UNITS

ASSIGNMENT SERIAL NO.	ASG.	TYPE	ST.	CTY.	FUND SYMBOL	ACRES/UNITS	RATE

AMOUNT	ANV. DATE	EXP. DATE	BILL CYC.	S/C	DISTRICT	NEXT BILL	MISC. DATA	U of M	ACTUAL UNITS

APPLY REMITTANCE			
ACTION	FUND SYMBOL	CTY.	AMOUNT
FILING FEE			
RENTAL			
UNEARNED			
REFUND			
TOTAL			
AMOUNT DUE			

Remarks:

BY: _____ DATE: _____

Lease in Escrow?
 KGS?
 Auto Escalates?
 Auto Renew?

Of Interest?
Operating Rights?
Operator
Bond Filed?

FOR MMS USE ONLY

BILLEE	FOREST REFUGE
NUMBER	
OCS SECTION	
CODE	

NOTICE!!

These documents have been scanned!

Do not place un-scanned documents beneath this notice!

Do not remove this notice from this file!

GPO Jacket No. 560-102
Print Order 61540
Rise Business Services, LLC
Job=AZ15 7/3/2019



Box Number= AZ15143



Claim Begin-End: AMC350201-AMC350202

2 Correspondence



AZ15143-1

AMC350775-AMC351108

**NO
DOCUMENTS
FOUND**

NO DOCUMENTS FOUND
NO DOCUMENTS FOUND

NOTICE!!

These documents have been scanned!

Do not place un-scanned documents beneath this notice!

Do not remove this notice from this file!

GPO Jacket No. 560-102
Print Order 61540
Rise Business Services, LLC
Job=AZ15 7/3/2019



Box Number= AZ15143



Claim Begin-End: AMC350201-AMC350202

3 Transfers



AZ15143-1

AMC350775-AMC351108

**NO
DOCUMENTS
FOUND**

NO DOCUMENTS FOUND
NO DOCUMENTS FOUND

NOTICE!!

These documents have been scanned!

Do not place un-scanned documents beneath this notice!

Do not remove this notice from this file!

GPO Jacket No. 560-102
Print Order 61540
Rise Business Services, LLC
Job=AZ15 7/3/2019



Box Number= AZ15143



Claim Begin-End: AMC350201-AMC350202

4 Annual Filings



AZ15143-1

AMC350775-AMC351108

350201

MAINTENANCE FEE PAYMENT

Claimant Name: Thomas J. Small
 Address: 361 E. Kaniksu St
 City: Apache Jct. State: AZ Zip: 85119
 Telephone: 480-220-0499
 E-mail address: Rockinghorse1953@live.com
 Signature: Thomas J. Small

Check here if this is a change of address.

RECEIVED
 ARIZONA STATE OFFICE
 2019 AUG 19 A 11:55
 PHOENIX, ARIZONA
 BLM
 Date
 Stamp

LINE NO.	AMC NUMBER	CLAIM/SITE NAME	COUNTY RECORDER DATA (If available)	TWP	RNG	SEC
1	350201	Rockinghorse #17	98-0180989	T-2N	8E	33
2	350202	Rockinghorse #18	98-0180988	T-2N	8E	33
3						
4						
5						
6						
7						
8						
9						
10						

List additional claims on Form MCF114.

**Bureau of Land Management
Arizona State Office**

<https://www.blm.gov/arizona>

No. of Claims*: _____ x \$165 = _____
 Check No: _____ Init. THM
 Receipt No.: 4536384
 For BLM Use Only

* \$165 per lode mining claim, mill site, or tunnel site; and \$165 for each 20 acres or portion thereof for each placer mining claim.

Form: MCF112
Revised July 2019

ENTERED
 AUG 20 2019
 BY: [Signature]

This form is available from the Arizona Geological Survey and may be reproduced.

SUPPLEMENTAL ATTACHMENT

May be used with the following forms for listing additional mining claims:

Check One.

- Affidavit of Performance of Annual Work
- Maintenance Fee Payment
- Notice of Intent to Hold Mining Claims
- Notice of Non-Liability for Labor and Materials Furnished
- Quit claim Deed

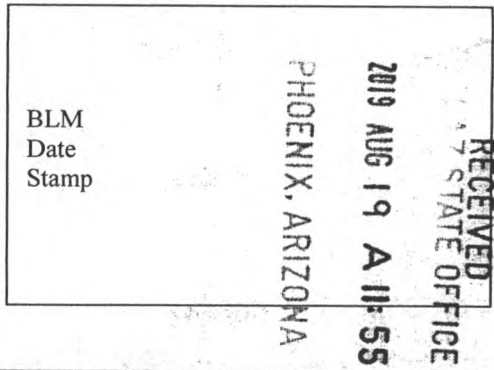

LINE NO.	AMC NUMBER	CLAIM/SITE NAME	COUNTY RECORDER DATA (If available)	TWP	RNG	SEC

United States Department of the Interior
Bureau of Land Management
 DIV OF LANDS, MINRLS & ENERGY
 ONE N CENTRAL AVE
 PHOENIX, AZ 85004 -4427
 Phone: 602-417-9200

Receipt	
No:	4536384

Transaction #: 4657292	
Date of Transaction: 08/19/2019	
CUSTOMER:	
THOMAS J SMALL 361 E KANIKSU ST APACHE JUNCTION, AZ 85119-9452 US	

LINE #	QTY	DESCRIPTION	REMARKS	UNIT PRICE	TOTAL
1	1.00	LOCATABLE MINERALS / MINING CLAIMS- NOT NEW-UNADJUD, ONE AUTH NO. ONLY / MINING CLAIM MONEY RECEIVED CASES: AMC350201/\$330.00	MAINT 2020/2	- n/a -	330.00
TOTAL:					\$330.00

PAYMENT INFORMATION			
1	AMOUNT:	330.00	POSTMARKED: N/A
	TYPE:	CHECK	RECEIVED: 08/19/2019
	CHECK NO:	5204	
	NAME:	SMALL, THOMAS J 361 E KANIKSU ST APACHE JUNCTION AZ 85119-9452 US	

REMARKS

This receipt was generated by the automated BLM Collections and Billing System and is a paper representation of a portion of the official electronic record contained therein.

Amc350201

MAINTENANCE FEE PAYMENT

Claimant Name: THOMAS J. SMALL
Address: 361 E. KAVIKSU ST
City: APACHE JCT. State: AZ Zip: 85119
Telephone: 480-220-0499
E-mail address: rockinghorse1953@live.com
Signature: Thomas J. Small

RECEIVED
BLM AZ STATE OFFICE
2010 AUG 30 A 11:27
PHOENIX, ARIZONA
BLM
Date
Stamp

Check here if this is a change of address.

LINE NO.	AMC NUMBER	CLAIM/SITE NAME	COUNTY RECORDER DATA (If available)	TWP	RNG	SEC
1	350761	Rockinghorse #17	98-0180989	T2N	8E	33
2	350702	Rockinghorse #18	98-0180988	T2N	8E	33
3						
4						
5						
6						
7						
8						
9						
10						

List additional claims on Form MCF114.

Bureau of Land Management
Arizona State Office
www.blm.gov/az/

AC 782 (2019)
ENTERED AUG 31 2010
PB

No. of Claims*: 2 x \$155 = 310
Check No: 5133 Init. PER
Receipt No.: 4250105
For BLM Use Only

* \$155 per lode mining claim, mill site, or tunnel site; and \$155 for each 20 acres or portion thereof for each placer mining claim.

Form: MCF112
Revised July 2014

This form is available from the Arizona Geological Survey and may be reproduced.

SUPPLEMENTAL ATTACHMENT

May be used with the following forms for listing additional mining claims:

Check One.

- Affidavit of Performance of Annual Work
- Maintenance Fee Payment
- Notice of Intent to Hold Mining Claims
- Notice of Non-Liability for Labor and Materials Furnished
- Quit claim Deed

BLM
Date
Stamp

PHOENIX, ARIZONA

2018 AUG 30 A H-21

RECEIVED
MINE STATE OFFICE

LINE NO.	AMC NUMBER	CLAIM/SITE NAME	COUNTY RECORDER DATA (if available)	RECORDS SECTION	SEC

United States Department of the Interior
Bureau of Land Management
 DIV OF LANDS, MINRLS & ENERGY
 ONE N CENTRAL AVE
 PHOENIX, AZ 85004 -4427
 Phone: 602-417-9200

Receipt

No: 4250105

Transaction #: 4365596	
Date of Transaction: 08/30/2018	
CUSTOMER:	
THOMAS J SMALL 361 E KANIKSU ST APACHE JUNCTION, AZ 85119-9452 US	

AC 782
 ENTERED AUG 31 2018
 JB

LINE #	QTY	DESCRIPTION	REMARKS	UNIT PRICE	TOTAL
1	1.00	LOCATABLE MINERALS / MINING CLAIMS-NOT NEW-UNADJUD, ONE AUTH NO. ONLY / MINING CLAIM MONEY RECEIVED CASES: AMC350201/\$310.00		- n/a -	310.00
TOTAL:					\$310.00

PAYMENT INFORMATION			
1	AMOUNT:	310.00	POSTMARKED: N/A
	TYPE:	CHECK	RECEIVED: 08/30/2018
	CHECK NO:	5133	
	NAME:	SMALL, THOMAS J 361 E KANIKSU ST APACHE JUNCTION AZ 85119-9452 US	

REMARKS

This receipt was generated by the automated BLM Collections and Billing System and is a paper representation of a portion of the official electronic record contained therein.

350201

MAINTENANCE FEE PAYMENT

Claimant Name: THOMAS J. SMALL

Address: 361 E. KAVIKSU ST.

City: APACHE JCT State: AZ Zip: 85119

Telephone: 480-220-0499

E-mail address: Rockinghorse1953@LIE.com

Signature: Thomas J. Small

Check here if this is a change of address.

BLM Date Stamp	RECEIVED
	BLM AZ STATE OFFICE
PHOENIX, ARIZONA	2011 AUG 11 A 10: 03

LINE NO.	AMC NUMBER	CLAIM/SITE NAME	COUNTY RECORDER DATA (If available)	TWP	RNG	SEC
1	350201	Rockinghorse #17	98-0180989	T-2N	8E	33
2	350202	Rockinghorse #18	98-0180988	T-2N	8E	33
3						
4						
5						
6						
7						
8						
9						
10						

List additional claims on Form MCF114.

**Bureau of Land Management
Arizona State Office**

www.blm.gov/az/

No. of Claims*:	<u>2</u>	x \$155 =	<u>310.00</u>
Check No:	<u>5052</u>	Init.	<u>ESG</u>
Receipt No.:	<u>3932409</u>		
For BLM Use Only			

* \$155 per lode mining claim, mill site, or tunnel site; and \$155 for each 20 acres or portion thereof for each placer mining claim.

Form: MCF112
Revised July 2014

This form is available from the Arizona Geological Survey and may be reproduced.

ENTERED
AUG 14 2017
BY: RAun

United States Department of the Interior
Bureau of Land Management
 DIV OF LANDS, MINRLS & ENERGY
 ONE N CENTRAL AVE
 PHOENIX, AZ 85004 -4427
 Phone: 602-417-9200

Receipt

No: 3932409

Transaction #: 4041984	
Date of Transaction: 08/11/2017	
CUSTOMER:	
THOMAS J SMALL 361 E KANIKSU ST APACHE JUNCTION, AZ 85119-9452 US	

LINE #	QTY	DESCRIPTION	REMARKS	UNIT PRICE	TOTAL
1	1.00	LOCATABLE MINERALS / MINING CLAIMS- NOT NEW-UNADJUD, ONE AUTH NO. ONLY / MINING CLAIM MONEY RECEIVED CASES: AMC350201/\$310.00	2018 MAINT (2)	- n/a -	310.00
TOTAL:					\$310.00

PAYMENT INFORMATION			
1	AMOUNT:	310.00	POSTMARKED: N/A
	TYPE:	CHECK	RECEIVED: 08/11/2017
	CHECK NO:	5052	
	NAME:	SMALL, THOMAS J 361 E KANIKSU ST APACHE JUNCTION AZ 85119-9452 US	

REMARKS

This receipt was generated by the automated BLM Collections and Billing System and is a paper representation of a portion of the official electronic record contained therein.

350201

MAINTENANCE FEE PAYMENT

Claimant Name: THOMAS J. SMALL
Address: 361 E. KAMIKSU ST.
City: APACHE JCT. State: AZ Zip: 85119
Telephone: 480-220-0499
E-mail address: Rockinghorse1953@live.com
Signature: Thomas J. Small

RECEIVED
BLM AZ STATE OFFICE
2016 AUG 11 P 1:01
PHOENIX, ARIZONA
BLM
Date
Stamp

Check here if this is a change of address.

LINE NO.	AMC NUMBER	CLAIM/SITE NAME	COUNTY RECORDER DATA (If available)	TWP	RNG	SEC
1	350201	Rockinghorse #17	98-0180989	F2N	8E	33
2	350202	Rockinghorse #18	98-0180988	F2N	8E	33
3						
4						
5						
6						
7						
8						
9						
10						

List additional claims on Form MCF114.

Bureau of Land Management
Arizona State Office
www.blm.gov/az/

No. of Claims*: 2 x \$155 = 310
Check No: CC Init. ESJ
Receipt No.: 3627995
For BLM Use Only

* \$155 per lode mining claim, mill site, or tunnel site; and \$155 for each 20 acres or portion thereof for each placer mining claim.

Form: MCF112
Revised July 2014

United States Department of the Interior
Bureau of Land Management
 DIV OF LANDS, MINRLS & ENERGY
 ONE N CENTRAL AVE
 PHOENIX, AZ 85004 -4427
 Phone: 602-417-9200

Receipt

No: 3627995

Transaction #: 3731757	
Date of Transaction: 08/11/2016	
CUSTOMER:	
THOMAS J SMALL 361 E KANIKSU ST APACHE JUNCTION, AZ 85119-9452 US	

LINE #	QTY	DESCRIPTION	REMARKS	UNIT PRICE	TOTAL
1	1.00	LOCATABLE MINERALS / MINING CLAIMS- NOT NEW-UNADJUD, ONE AUTH NO. ONLY / MINING CLAIM MONEY RECEIVED CASES: AMC350201/\$310.00	2017 MAINT (2)	- n/a -	310.00
TOTAL:					\$310.00

PAYMENT INFORMATION			
NOTE: Items will appear on credit card statement as "Bureau of Land Mgmt CO".			
1	AMOUNT:	310.00	POSTMARKED: N/A
	TYPE:	CREDIT CARD	RECEIVED: 08/11/2016
	NAME:	SMALL, THOMAS J 361 E KANIKSU ST APACHE JUNCTION AZ 85119-9452 US	
	CARD NO:	XXXXXXXXXXXX4479	AUTH CODE: 06614Z
	NAME ON CARD:	THOMAS J SMALL	
	EXPIRES:	03/2020	
	SIGNATURE:		

REMARKS

This receipt was generated by the automated BLM Collections and Billing System and is a paper representation of a portion of the official electronic record contained therein.



350201

MAINTENANCE FEE PAYMENT

Claimant Name: THOMAS J. SMALL
Address: 361 E. KAVIKSU ST.
City: APACHE JCT. State: AZ Zip: 85119
Telephone: 480-220-0499
E-mail address: Rockinghorse1953@live.com
Signature: Thomas J. Small

RECEIVED
BLM AZ STATE OFFICE
2015 AUG 19 A 11:09
PHOENIX, ARIZONA
BLM
Date
Stamp

Check here if this is a change of address.

LINE NO.	AMC NUMBER	CLAIM/SITE NAME	COUNTY RECORDER DATA (If available)	TWP	RNG	SEC
1	350201	ROCKINGHORSE #17	98-0180989	T2N	8E	33
2	350202	ROCKINGHORSE #18	98-0180988	T2N	8E	33
3						
4						
5						
6						
7						
8						
9						
10						

List additional claims on Form MCF114.

No. of Claims*: 2 x \$155 = 310
Check No: 4813 Init. PER
Receipt No.: 3370849
For BLM Use Only

Bureau of Land Management
Arizona State Office
www.blm.gov/az/

* \$155 per lode mining claim, mill site, or tunnel site; and \$155 for each 20 acres or portion thereof for each placer mining claim.

Form: MCF112
Revised July 2014

ENTERED
AUG 25 2015
BY: JS

This form is available from the **Arizona Geological Survey** and may be reproduced.

United States Department of the Interior
Bureau of Land Management
 LANDS/RECREATION & PLANNING
 ONE N CENTRAL AVE
 PHOENIX, AZ 85004 -2203
 Phone: 602-417-9200

Receipt

No: 3370849

Transaction #: 3469010	
Date of Transaction: 08/19/2015	
CUSTOMER:	
THOMAS J SMALL 361 E KANIKSU ST APACHE JUNCTION, AZ 85119-9452 US	

LINE #	QTY	DESCRIPTION	REMARKS	UNIT PRICE	TOTAL
1	1.00	LOCATABLE MINERALS / MINING CLAIMS-NOT NEW-UNADJUD, ONE AUTH NO. ONLY / MINING CLAIM MONEY RECEIVED CASES: AMC350201/\$310.00	2016 MAINT/2	- n/a -	310.00
TOTAL:					\$310.00

PAYMENT INFORMATION					
1	AMOUNT:	310.00	POSTMARKED:	N/A	
	TYPE:	CHECK	RECEIVED:	08/19/2015	
	CHECK NO:	4873			
	NAME:	SMALL, THOMAS J 361 E KANIKSU ST APACHE JUNCTION AZ 85119-9452 US			

REMARKS

This receipt was generated by the automated BLM Collections and Billing System and is a paper representation of a portion of the official electronic record contained therein.

AMC350201

MAINTENANCE FEE PAYMENT

Claimant Name: Thomas J. Small
Address: 361 E. Kaniksu St.
City: Apache Jct. State: AZ Zip: 85119
Telephone: 480-671-1053
E-mail address: Rockinghorse1953@live.com
Signature: Thomas J. Small

Check here if this is a change of address.

RECEIVED
BLM AZ STATE OFFICE
2014 AUG 13 A 10:46
PHOENIX, ARIZONA
BLM
Date
Stamp

LINE NO.	AMC NUMBER	CLAIM/SITE NAME	COUNTY RECORDER DATA (If available)	TWP	RNG	SEC
1	350201	Rockinghorse #17	98-0180989	T-2N	8E	33
2	350202	Rockinghorse #18	98-0180988	T-2N	8E	33
3						
4						
5						
6						
7						
8						
9						
10						

List additional claims on Form MCF114.

Bureau of Land Management
Arizona State Office
www.blm.gov/az/

No. of Claims: 2 x \$155 = 310
Check No: 4758 Init. JML
Receipt No.: 3100143
For BLM Use Only

Form: MCF112
Revised July 2009

This form is available from the Arizona Department of Mines and Mineral Resources and may be reproduced.

ENTERED
AUG 14 2014
BY: RAM

United States Department of the Interior
Bureau of Land Management
 LANDS/RECREATION & PLANNING
 ONE N CENTRAL AVE
 PHOENIX, AZ 85004 -2203
 Phone: 602-417-9200

ENTERED
 AUG 14 2014
 BY: *RAM*

Receipt

No:

3100143

Transaction #: 3191686	
Date of Transaction: 08/13/2014	
CUSTOMER:	
THOMAS J SMALL 361 E KANIKSU ST APACHE JUNCTION, AZ 85119-9452 US	

LINE #	QTY	DESCRIPTION	REMARKS	UNIT PRICE	TOTAL
1	1.00	LOCATABLE MINERALS / MINING CLAIMS- NOT NEW-UNADJUD, ONE AUTH NO. ONLY / MINING CLAIM MONEY RECEIVED CASES: AMC350201/\$310.00	MAINT 2015/2	- n/a -	310.00
TOTAL:					\$310.00

PAYMENT INFORMATION					
1	AMOUNT:	310.00	POSTMARKED:	N/A	
	TYPE:	CHECK	RECEIVED:	08/13/2014	
	CHECK NO:	4758			
	NAME:	SMALL, THOMAS J 361 E KANIKSU ST APACHE JUNCTION AZ 85119-9452 US			

REMARKS

This receipt was generated by the automated BLM Collections and Billing System and is a paper representation of a portion of the official electronic record contained therein.

350296

350201

MAINTENANCE FEE PAYMENT

Claimant Name: THOMAS J. SMALL

Address: 361 E. KAWIKSU ST.

City: AAOHE SCT. State: AZ Zip: 85119

Telephone: 480-671-1053

E-mail address: ROCKINGHORSE1953@LIVE.COM

Signature: Thomas J. Small

Check here if this is a change of address.

RECEIVED
 MINERAL STATE OFFICE
 PHOENIX, ARIZONA
 2013 AUG 19 A 11:26
 BLM
 Date
 Stamp

LINE NO.	AMC NUMBER	CLAIM/SITE NAME	COUNTY RECORDER DATA (If available)	TWP	RNG	SEC
1	350296	Rockinghorse #14	98-0503702	T-2N	8E	33
2	350201	Rockinghorse #17	98-0180989	"	"	"
3	350202	Rockinghorse #18	98-0180988	"	"	"
4	350297	Rockinghorse #39	98-0503703	"	"	"
5						
6						
7						
8						
9						
10						

List additional claims on Form MCF114.

Bureau of Land Management
Arizona State Office
www.blm.gov/az/

No. of Claims: 4 x \$140 = 560
 Check No: 4649 Init. JMS
 Receipt No.: 2858630
 For BLM Use Only

Form: MCF112
Revised July 2009

This form is available from the Arizona Department of Mines and Mineral Resources and may be reproduced.

ENTERED
 AUG 23 2013
 BY: RE

**United States Department of the Interior
Bureau of Land Management
LANDS/RECREATION & PLANNING
ONE N CENTRAL AVE
PHOENIX, AZ 85004 -2203
Phone: 602-417-9200**

Receipt

No:

2858630

Transaction #: 2944464	
Date of Transaction: 08/19/2013	
CUSTOMER:	
THOMAS J SMALL 361 E KANIKSU ST APACHE JUNCTION, AZ 85119-9452 US	

LINE #	QTY	DESCRIPTION	REMARKS	UNIT PRICE	TOTAL
1	1.00	LOCATABLE MINERALS / MINING CLAIMS-NOT NEW-UNADJUD, ONE AUTH NO. ONLY / MINING CLAIM MONEY RECEIVED CASES: AMC350296/\$560.00	MAINT 2014/4	- n/a -	560.00
TOTAL:					\$560.00

PAYMENT INFORMATION					
1	AMOUNT:	560.00	POSTMARKED:	N/A	
	TYPE:	CHECK	RECEIVED:	08/19/2013	
	CHECK NO:	4642			
	NAME:	SMALL, THOMAS J 361 E KANIKSU ST APACHE JUNCTION AZ 85119-9452 US			

REMARKS	

This receipt was generated by the automated BLM Collections and Billing System and is a paper representation of a portion of the official electronic record contained therein.

Amc # 350296
 Amc 350201

MAINTENANCE FEE PAYMENT

Claimant Name: THOMAS T. SMALL
 Address: 361 E. HANCOCK ST.
 City: APACHE JCT. State: AZ Zip: 85119
 Telephone: 480-671-1053
 E-mail address: ROCKINGHORSE1953@Live.com
 Signature: Thomas T. Small

RECEIVED
 BLM AZ STATE OFFICE
 PHOENIX, ARIZONA
 2012 AUG - 9 A 11: 16
 BLM
 Date
 Stamp

Check here if this is a change of address.

LINE NO.	AMC NUMBER	CLAIM/SITE NAME	COUNTY RECORDER DATA (If available)	TWP	RNG	SEC
1	350296	Rockinghorse # 14	98-0503702	T-2N	8E	33
2	350201	Rockinghorse # 17	98-0180989	"	"	"
3	350202	Rockinghorse # 18	98-0180988	"	"	"
4	350297	Rockinghorse # 39	98-0503703	"	"	"
5						
6						
7						
8						
9						
10						

List additional claims on Form MCF114.

Bureau of Land Management
 Arizona State Office
 www.blm.gov/az/

No. of Claims: 4 x \$140 = 560.00
 Check No: 4516 Init. ESG
 Receipt No.: 2626505
 For BLM Use Only

Form: MCF112
 Revised July 2009

This form is available from the Arizona Department of Mines and Mineral Resources and may be reproduced.

ENTERED INTO COMPUTER
 8/22/12 AT

United States Department of the Interior
Bureau of Land Management
 LANDS/RECREATION & PLANNING
 ONE N CENTRAL AVE
 PHOENIX, AZ 85004 -2203
 Phone: 602-417-9200

Receipt

No: 2626505

Transaction #: 2706937	
Date of Transaction: 08/09/2012	
CUSTOMER:	
THOMAS J SMALL 361 E KANIKSU ST APACHE JUNCTION, AZ 85119-9452 US	

LINE #	QTY	DESCRIPTION	REMARKS	UNIT PRICE	TOTAL
1	1.00	LOCATABLE MINERALS / MINING CLAIMS- NOT NEW-UNADJUD, ONE AUTH NO. ONLY / MINING CLAIM MONEY RECEIVED CASES: AMC350296/\$560.00	MAINT (4)	- n/a -	560.00
TOTAL:					\$560.00

PAYMENT INFORMATION					
1	AMOUNT:	560.00	POSTMARKED:	N/A	
	TYPE:	CHECK	RECEIVED:	08/09/2012	
	CHECK NO:	4516			
	NAME:	SMALL, THOMAS J 361 E KANIKSU ST APACHE JUNCTION AZ 85119-9452 US			

REMARKS

This receipt was generated by the automated BLM Collections and Billing System and is a paper representation of a portion of the official electronic record contained therein.

AMC 350296

350201

MAINTENANCE FEE PAYMENT

Claimant Name: Thomas J. Small ✓
 Address: 361 E. KAWIKSU ST.
 City: APACHE JCT. State: AZ Zip: 85119
 Telephone: 480-671-1053
 E-mail address: ROCKINGHORSE1953@LINE.COM
 Signature: Thomas J. Small

Check here if this is a change of address.

RECEIVED
 ARIZONA STATE OFFICE
 PHOENIX, ARIZONA
 2011 AUG 10 A 10:52
 BLM
 Date
 Stamp

LINE NO.	AMC NUMBER	CLAIM/SITE NAME	COUNTY RECORDER DATA (If available)	TWP	RNG	SEC
1	350296	Rockinghorse # 14	98-0503702	T-2N	8E	33
2	350201	Rockinghorse # 17	98-0180989	"	"	"
3	350202	Rockinghorse # 18	98-0180988	"	"	"
4	350297	Rockinghorse # 39	98-0503703	"	"	"
5						
6						
7						
8						
9						
10						

ENTERED INTO COMPUTER
AUG 11 2011 JB

List additional claims on Form MCF114.

Bureau of Land Management
Arizona State Office
www.blm.gov/az/

No. of Claims: 4 x \$140 = 560
 Check No: 43811 Init. JMC
 Receipt No.: 2401252
For BLM Use Only

Form: MCF112
 Revised July 2009

United States Department of the Interior
 Bureau of Land Management
 LANDS/RECREATION & PLANNING
 ONE N CENTRAL AVE
 PHOENIX, AZ 85004 -2203
 Phone: 602-417-9200

Receipt

No:

2401252

Transaction #: 2476439		ENTERED INTO COMPUTER
Date of Transaction: 08/10/2011		
CUSTOMER:		AUG 11 2011 <i>ps</i>
THOMAS J SMALL 361 E KANIKSU ST APACHE JUNCTION, AZ 85119-9452 US		

LINE #	QTY	DESCRIPTION	REMARKS	UNIT PRICE	TOTAL
1	1.00	LOCATABLE MINERALS / MINING CLAIMS-NOT NEW-UNADJUD, ONE AUTH NO. ONLY / MINING CLAIM MONEY RECEIVED CASES: AMC350296/\$560.00	MAINT 2012/4	- n/a -	560.00
TOTAL:					\$560.00

PAYMENT INFORMATION					
1	AMOUNT:	560.00	POSTMARKED:	N/A	
	TYPE:	CHECK	RECEIVED:	08/10/2011	
	CHECK NO:	4381			
	NAME:	SMALL, THOMAS J 361 E KANIKSU ST APACHE JUNCTION AZ 85119-9452 US			

REMARKS

This receipt was generated by the automated BLM Collections and Billing System and is a paper representation of a portion of the official electronic record contained therein.

AMC 350 296

350201

MAINTENANCE FEE PAYMENT

Claimant Name: THOMAS F. SMALL

Address: 361 E. KAMIKSU ST.

City: AVATE ST State: AZ Zip: 85719 ✓

Telephone: 480-671-1053

E-mail address: _____

Signature: Thomas F. Small

Check here if this is a change of address.

BLM
Date
Stamp

RECEIVED
BLM ARIZONA STATE OFFICE
2010 AUG 24 A 9:53
PHOENIX, ARIZONA

LINE NO.	AMC NUMBER	CLAIM/SITE NAME	COUNTY RECORDER DATA (If available)	TWP	RNG	SEC
1	350296	Rocking Horse #14	98-0503702			
2	350201	Rocking Horse #17	98-0180789			
3	350202	Rocking Horse #18	98-0180988			
4	350297	Rocking Horse #39	98-0503703			
5						
6						
7						
8						
9						
10						

ENTERED INTO COMPUTER
SEP 08 2010 M

List additional claims on Form MCF114.

Bureau of Land Management
Arizona State Office

www.blm.gov/az

No. of Claims: 4 x \$140 = 560.00
 Check No: 4260 Init. A.F.
 Receipt No.: 2198359
 For BLM Use Only

Form: MCF112
Revised July 2009

This form is available from the Arizona Department of Mines and Mineral Resources and may be reproduced.

**United States Department of the Interior
Bureau of Land Management
LANDS/RECREATION & PLANNING
ONE N CENTRAL AVE
PHOENIX, AZ 85004 -2203**

Receipt

No: 2198359

Phone:

Transaction #: 2268260		ENTERED INTO COMPUTER SEP 08 2010 M
Date of Transaction: 08/24/2010		
CUSTOMER:	THOMAS J SMALL 361 E KANIKSU ST ✓ APACHE JUNCTION, AZ 85219-9452 US	

LINE #	QTY	DESCRIPTION	REMARKS	UNIT PRICE	TOTAL
1	1.00	LOCATABLE MINERALS / MINING CLAIMS- NOT NEW-UNADJUD, ONE AUTH NO. ONLY / MINING CLAIM MONEY RECEIVED CASES: AMC350296/\$560.00	MAINT FEE PYMNT (4) 2011	- n/a -	560.00 ✓
TOTAL:					\$560.00

PAYMENT INFORMATION			
1	AMOUNT:	560.00	POSTMARKED: N/A
	TYPE:	CHECK	RECEIVED: 08/24/2010
	CHECK NO:	4260	
	NAME:	SMALL, THOMAS J 361 E KANIKSU ST APACHE JUNCTION AZ 85219-9452 US	

REMARKS	

This receipt was generated by the automated BLM Collections and Billing System and is a paper representation of a portion of the official electronic record contained therein.

AMC353995
 349578
 350296
 350437
 350201
 352009

MAINTENANCE FEE PAYMENT

Claimant Name: THOMAS J. SMALL
 Address: 361 E. KANIKSU ST.
 City: APACHE JCT State: AZ Zip: 85119
 Telephone: 480-671-1053
 E-mail address: ECLIPTICACTZERO.NET
 Signature: Thomas J. Small

Check here if this is a change of address.

RECEIVED
 PHOENIX, ARIZONA
 2009 AUG 12 A 10: 12
 PHOENIX STATE OFFICE
 BLM
 Date
 Stamp

LINE NO.	AMC NUMBER	CLAIM/SITE NAME	COUNTY RECORDER DATA (If available)	TWP	RNG	SEC
L 1	353995	ROCKING HORSE #2	2000-0470802			
L 2	349578	ROCKING HORSE #4	98-0082685			
3	349579	ROCKING HORSE #5	98-0082683			
4	349580	ROCKING HORSE #6	98-0082684			
L 5	350296	ROCKING HORSE #14	98-0503702			
L 6	350201	ROCKING HORSE #17	98-0180989			
7	350202	ROCKING HORSE #18	98-0180988			
8	352011	ROCKING HORSE #19	99-0057320			
9	350297	ROCKING HORSE #39	98-0503703			
10	350439	ROCKING HORSE #3	99-0988270 99-0988271			

List additional claims on Form MCF114.

Bureau of Land Management
Arizona State Office
www.az.blm.gov

No. of Claims: 10 x \$140 = \$1400
 Check No: CC Init. ERG
 Receipt No.: 1975569
 For BLM Use Only

Form: MCF112
 Revised July 2009

This form is available from the **Arizona Department of Mines and Mineral Resources** and may be reproduced.

ENTERED INTO COMPUTER
 8/21/09 DJJ

United States Department of the Interior
Bureau of Land Management
 BUSINESS & SUPPORT SVCS DIV
 ONE N CENTRAL AVE SUITE 800
 PHOENIX, AZ 85004 -4427
 Phone: (602) 417-9200

Receipt

No: 1975569

Transaction #: 2039531	
Date of Transaction: 08/12/2009	
CUSTOMER:	THOMAS J SMALL 361 E KANIKSU ST APACHE JUNCTION, AZ 85219-9452 US

LINE #	QTY	DESCRIPTION	REMARKS	UNIT PRICE	TOTAL
1	1.00	LOCATABLE MINERALS / MINING CLAIMS- NOT NEW-UNADJUD, ONE AUTH NO. ONLY / MINING CLAIM MONEY RECEIVED CASES: AMC353995/\$1400.00	2010 MAINT (10)	- n/a -	1400.00
TOTAL:					\$1,400.00

PAYMENT INFORMATION					
NOTE: Items will appear on credit card statement as "Bureau of Land Mgmt CO".					
1	AMOUNT:	1400.00	POSTMARKED:	N/A	
	TYPE:	CREDIT CARD	RECEIVED:	08/12/2009	
	NAME:	SMALL, THOMAS J 361 E KANIKSU ST APACHE JUNCTION AZ 85219-9452 US			
	CARD NO:	XXXXXXXXXXXX1242	AUTH CODE:	06665Z	
	NAME ON CARD:	THOMAS J SMALL			
	EXPIRES:	07/2010			
	SIGNATURE:				

REMARKS

This receipt was generated by the automated BLM Collections and Billing System and is a paper representation of a portion of the official electronic record contained therein.

AMC353995
 AMC349578
 AMC350201
 AMC352009
 AMC350296
 AMC350437
 AMC333410

MAINTENANCE FEE PAYMENT

Claimant Name: THOMAS T. SMALL
 Address: 361 E. KARUKSU ST.
 City: APACHE JCT. State: AZ Zip: 85219
 Telephone: 480-671-1053
 E-mail address: ECLIPSE@NETTERR.NET
 Signature: Thomas T. Small

Check here if this is a change of address.

RECEIVED
 PLM AZ STATE OFFICE
 2008 AUG 25 A 10:36
 PHOENIX, ARIZONA
 BLM
 Date
 Stamp

LINE NO.	AMC NUMBER	CLAIM/SITE NAME	COUNTY RECORDER DATA (If available)	TWP	RNG	SEC
1	353995	ROCKING HORSE #2	2000-0470802			
2	349578	ROCKING HORSE #4	98-0082685			
3	349579	ROCKING HORSE #5	98-0082683			
4	349580	ROCKING HORSE #6	98-0082684			
5	350296	ROCKING HORSE #14	98-0503702			
6	350201	ROCKING HORSE #17	98-0180989			
7	350202	ROCKING HORSE #18	98-0180988			
8	352011	ROCKING HORSE #19	99-0057370			
9	350297	ROCKING HORSE #39	98-0503703 99-0988270			
10	350439	ROCKING HORSE #3	99-0988271			

List additional claims on Form MCF114.

Bureau of Land Management
 Arizona State Office
www.az.blm.gov

No. of Claims: 11 x \$125 = 1,375⁰⁰
 Check No: CC Init. SC
 Receipt No.: 1769512
 For BLM Use Only

Form: MCF112
 Revised July 2005

This form is available from the Arizona Department of Mines and Mineral Resources and may be reproduced.

ENTERED INTO COMPUTER
 9/11/08 AB

SUPPLEMENTAL ATTACHMENT

May be used with the following forms for listing additional mining claims:

Check One.

- Affidavit of Performance of Annual Work
- Maintenance Fee Payment
- Notice of Intent to Hold Mining Claims
- Notice of Non-Liability for Labor and Materials Furnished

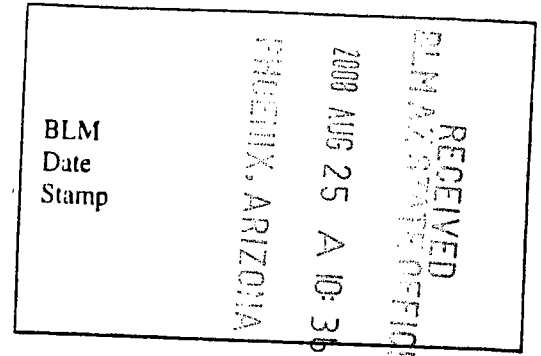

LINE NO.	AMC NUMBER	CLAIM/SITE NAME	COUNTY RECORDER DATA (If available)	TWP	RNG	SEC
11	330410	Rocking Horse #2	94-0341304			

Form MCF114
Revised June 2005

United States Department of the Interior
Bureau of Land Management
 BUSINESS & SUPPORT SVCS DIV
 ONE N CENTRAL AVE SUITE 800
 PHOENIX, AZ 85004 -4427
 Phone: (602) 417-9200

Receipt

No: 1769512

Transaction #: 1827181	
Date of Transaction: 08/25/2008	
CUSTOMER:	THOMAS J SMALL 361 E KANIKSU ST APACHE JUNCTION, AZ 85219

LINE #	QTY	DESCRIPTION	REMARKS	UNIT PRICE	TOTAL
1	1.00	LOCATABLE MINERALS / MINING CLAIMS-NOT NEW-UNADJUD, ONE AUTH NO. ONLY / MINING CLAIM MONEY RECEIVED (455) CASES: AMC353995/\$1375.00	MAINT 2009 (11)	- n/a -	1375.00
TOTAL:					\$1,375.00

PAYMENT INFORMATION			
NOTE: Items will appear on credit card statement as "Bureau of Land Mgmt CO".			
1	AMOUNT:	\$1,375.00	POSTMARKED: N/A
	TYPE:	CREDIT CARD	RECEIVED: 08/25/2008
	NAME:	SMALL, THOMAS J 361 E KANIKSU ST APACHE JUNCTION AZ 85219	
	CARD NO:	XXXXXXXXXXXX1242	AUTH CODE: 07746Z
	NAME ON CARD:	THOMAS J SMALL	
	EXPIRES:	07/31/2010	
	SIGNATURE:		

REMARKS

This receipt was generated by the automated BLM Collections and Billing System and is a paper representation of a portion of the official electronic record contained therein.

AMC 353995
 AMC 349578
 AMC 350201
 AMC 352009
 AMC 350296
 AMC 350437
 AMC 330410

MAINTENANCE FEE PAYMENT

Claimant Name: Thomas J. Small
 Address: 361 E. Kamikawa Tr.
 City: Apache Feet State: AZ Zip: 85311
 Telephone: 480-671-1053
 E-mail address: ECLIPTIS@NETTERR.COM
 Signature: Thomas J. Small

Check here if this is a change of address.

RECEIVED
 BLM, AZ STATE OFFICE
 2007 AUG 22 A 10:35
 PHOENIX, ARIZONA
 BLM
 Date
 Stamp

LINE NO.	AMC NUMBER	CLAIM/SITE NAME	COUNTY RECORDER DATA (If available)	TWP	RNG	SEC
1	353995	Rocking Horse #2				
2	341578	Rocking Horse #4				
3	349579	Rocking Horse #5				
4	349580	Rocking Horse #6				
5	350296	Rocking Horse #14				
6	350201	Rocking Horse #17				
7	350202	Rocking Horse #18				
8	352011	Rocking Horse #19				
9	350297	Rocking Horse #39				
10	350437	Rocking Horse #3				

List additional claims on Form MCF114.

Bureau of Land Management
 Arizona State Office
www.az.blm.gov

No. of Claims: 11 x \$125 = 1375.00
 Check No: CC Init. ERG
 Receipt No.: 1549994
 For BLM Use Only

Form: MCF112
 Revised July 2005

This form is available from the Arizona Department of Mines and Mineral Resources and may be reproduced.

RE 9/19/07

SUPPLEMENTAL ATTACHMENT

May be used with the following forms for listing additional mining claims:

Check One.

- Affidavit of Performance of Annual Work
- Maintenance Fee Payment
- Notice of Intent to Hold Mining Claims
- Notice of Non-Liability for Labor and Materials Furnished

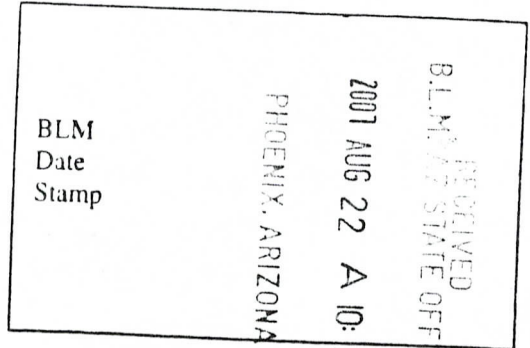

LINE NO.	AMC NUMBER	CLAIM/SITE NAME	COUNTY RECORDER DATA (If available)	TWP	RNG	SEC
11	330410	ROCKING HORSE #1	94-0341304			

Form MCF114
Revised June 2005

This form is available from the Arizona Department of Mines & Mineral Resources and may be reproduced.

United States Department of the Interior
Bureau of Land Management
 BUSINESS & SUPPORT SVCS DIV
 ONE N CENTRAL AVE SUITE 800
 PHOENIX, AZ 85004 -4427
 Phone: (602) 417-9200

Receipt

No: 1549994

Transaction #: 1601486	
Date of Transaction: 08/22/2007	
CUSTOMER:	THOMAS J SMALL 361 E KANIKSU ST APACHE JUNCTION, AZ 85219

LINE #	QTY	DESCRIPTION	REMARKS	UNIT PRICE	TOTAL
1	1.00	LOCATABLE MINERALS / MINING CLAIMS- NOT NEW-UNADJUD, ONE AUTH NO. ONLY / MINING CLAIM MONEY RECEIVED (455) CASES: AMC353995/\$1375.00	MAINT 2008 (11)	- n/a -	1375.00
TOTAL:					\$1,375.00

PAYMENT INFORMATION			
NOTE: Items will appear on credit card statement as "Bureau of Land Management".			
1	AMOUNT:	\$1,375.00	POSTMARKED: N/A
	TYPE:	CREDIT CARD	RECEIVED: 08/22/2007
	NAME:	SMALL, THOMAS J 361 E KANIKSU ST APACHE JUNCTION AZ 85219	
	CARD NO:	XXXXXXXXXXXX9259	AUTH CODE: 07641Z
	NAME ON CARD:	THOMAS J SMALL	
	EXPIRES:	07/31/2010	
	SIGNATURE:		

REMARKS

This receipt was generated by the automated BLM Collections and Billing System and is a paper representation of a portion of the official electronic record contained therein.

AMC 350201
 AMC 330410
 AMC 353995
 AMC 349578
 AMC 350296

AMC 350437
 AMC 352009

MAINTENANCE FEE PAYMENT

Claimant Name: THOMAS T. SMALL
 Address: 361 E. KANIKSU ST.
 City: APACHE JCT. State: AZ Zip: 85219
 Telephone: 480-671-1053
 E-mail address: ECLIPSE[®]NETZEPD.COM
 Signature: [Handwritten Signature]

Check here if this is a change of address.

RECEIVED
 BLM, AZ STATE OFFICE
 2005 AUG 25 A 11:02
 TUCSON, ARIZONA
 BLM
 Date
 Stamp

LINE NO.	AMC NUMBER	CLAIM/SITE NAME	COUNTY RECORDER DATA (If available)	TWP	RNG	SEC
1	353995	ROCKING HORSE #2	2000-0470802			
2	349578	ROCKING HORSE #4	98-0682685			
3	349579	ROCKING HORSE #5	98-0682683			
4	349580	ROCKING HORSE #6	98-0682684			
5	350296	ROCKING HORSE #14	98-0503702			
6	350201	ROCKING HORSE #17	98-0180987			
7	350202	ROCKING HORSE #18	98-0180988			
8	352011	ROCKING HORSE #19	99-0057320			
9	350297	ROCKING HORSE #39	98-0503703			
10	350439	ROCKING HORSE #3	99-0988270 99-0988271			

List additional claims on Form MCF114.

Bureau of Land Management
 Arizona State Office
www.az.blm.gov

No. of Claims: 11 x \$125 = 1,375.00
 Check No: CC Init. SC
 Receipt No.: _____
 For BLM Use Only

Form: MCF112
 Revised July 2005

This form is available from the Arizona Department of Mines and Mineral Resources and may be reproduced.

ENTERED IN COMPUTER
 RE 9/6/05

SUPPLEMENTAL ATTACHMEN

RECEIVED
BLM, AZ STATE OFFICE
PHOENIX, ARIZONA
2005 AUG 25 A 11: 02

BLM
Date
Stamp

May be used with the following forms for listing additional mining claims:

Check One.

- Affidavit of Performance of Annual Work
- Maintenance Fee Payment
- Notice of Intent to Hold Mining Claims
- Notice of Non-Liability for Labor and Materials Furnished

LINE NO.	AMC NUMBER	CLAIM/SITE NAME	COUNTY RECORDER DATA (If available)	TWP	RNG	SEC
11	330410	ROCKING HORSE # 1	94-0341304			

Form MCF114
Revised June 2005

This form is available from the Arizona Department of Mines & Mineral Resources and may be reproduced.

ENTERED BY REGISTER
RE 9/6/05

United States Department of the Interior
Bureau of Land Management
 BUSINESS & SUPPORT SVCS DIV
 222 N CENTRAL AVE
 PHOENIX, AZ 85004 -2203
 Phone: (602) 417-9200

Receipt	
No:	1137182

Transaction #: 1176328
Date of Transaction: 08/25/2005
CUSTOMER: THOMAS J SMALL 361 E KANIKSU APACHE JUNCTION, AZ 85219

LINE #	QTY	DESCRIPTION	REMARKS	UNIT PRICE	TOTAL
1	1.00	LOCATABLE MINERALS / MINING CLAIMS-NOT NEW-UNADJUD, ONE AUTH NO. ONLY / MINING CLAIM MONEY RECEIVED (455) CASES: AMC353995/\$1375.00	MAINT 2006 (11)	- n/a -	1375.00
TOTAL:					\$1,375.00

PAYMENT INFORMATION			
NOTE: Items will appear on credit card statement as "Bureau of Land Management".			
1	AMOUNT:	\$1,375.00	POSTMARKED: N/A
	TYPE:	CREDIT CARD	RECEIVED: 08/25/2005
	NAME:	SMALL, THOMAS J 361 E KANIKSU APACHE JUNCTION AZ 85219	
	CARD NO:	XXXXXXXXXXXX9259	AUTH CODE: 293275
	NAME ON CARD:	THOMAS J SMALL	
	EXPIRES:	07/31/2006	
	SIGNATURE:		

REMARKS

This receipt was generated by the automated BLM Collections and Billing System and is a paper representation of a portion of the official electronic record contained therein.

353995
 349578
 350296
 350201
 352009
 SC

MAINTENANCE FEE PAYMENT

Mining Claim Maintenance Fee Payment of \$100 per claim or site is due on or before September 1, 2004, in lieu of assessment work for the upcoming assessment year beginning September 1 of the year noted above.

BUREAU OF LAND MANAGEMENT
 ARIZONA STATE OFFICE
 222 NORTH CENTRAL AVENUE
 PHOENIX, AZ 85004
 602-417-9200
 www.az.blm.gov

FOR BLM USE ONLY	
NO. OF CLAIMS: <u>15</u>	X \$100 = \$ <u>1875.00</u>
RECEIPT NO: <u>935097</u>	CHECK NO: <u>Credit Card</u>
INIT: <u>SC</u>	

BLM SERIAL NUMBERS	NAME OF CLAIMS/SITES	COUNTY BOOK/DOCKET & PAGE OR FEE NUMBER
1. AMC <u>353995</u>	<u>ROCKING HORSE #2</u>	<u>2000-0470802</u>
2. AMC <u>349578</u>	<u># 4</u>	<u>98-0082685</u>
3. AMC <u>349579</u>	<u># 5</u>	<u>98-0082683</u>
4. AMC <u>349580</u>	<u># 6</u>	<u>98-0082684</u>
5. AMC <u>353996</u>	<u># 8</u>	<u>2000-0470800</u>
6. AMC <u>350296</u>	<u># 14</u>	<u>98-0503702</u>
7. AMC <u>350201</u>	<u># 17</u>	<u>98-0180989</u>
8. AMC <u>350202</u>	<u># 18</u>	<u>98-0180988</u>
9. AMC <u>352011</u>	<u># 19</u>	<u>99-0057320</u>
10. AMC <u>350297</u>	<u># 39</u>	<u>98-0503703</u>

List additional claims on the reverse side of this form.

CHECK HERE IF THIS IS A CHANGE OF ADDRESS

CLAIMANT'S NAME: THOMAS F. SMALL

ADDRESS: 361 E KANIKSU ST.

CITY: APACHE JUNCTION STATE: AZ ZIP: 85219

PHONE: 480-671-1053

Signature: Thomas F. Small

To record with the County, one claimant or an agent must sign.

PHOENIX, ARIZONA	2004 AUG 23 P 1:38	RECEIVED B.L.M. AZ STATE OFFICE
------------------	--------------------	------------------------------------

Verify 10/22/04
ENTERED INTO COMPUTER
8/30/04 AB

11. AMC <u>352012</u>	<u>ROCKING HORSE # 54</u>	<u>99-0057315</u>
12. AMC <u>352013</u>	<u># 55</u>	<u>99-0057319</u>
13. AMC <u>352014</u>	<u># 56</u>	<u>99-0061273</u>
14. AMC <u>350439</u>	<u># 3</u>	<u>99-0988270</u>
15. AMC <u>330410</u>	<u># 1</u>	<u>99-0988271</u>
16. AMC _____	_____	<u>94-0341304</u>
17. AMC _____	_____	_____
18. AMC _____	_____	_____
19. AMC _____	_____	_____
20. AMC _____	_____	_____

43 CFR 3833.0-5(e) (August 30, 1994) requires that the names of all of the owners and their current addresses shall be identified on all instruments required to be recorded or filed by the regulation, 43 CFR Subpart 3833.

NAME: _____ ADDRESS: _____
 CITY: _____ STATE: _____ ZIP: _____ IS THIS A NEW ADDRESS ..

NAME: _____ ADDRESS: _____
 CITY: _____ STATE: _____ ZIP: _____ IS THIS A NEW ADDRESS ..

NAME: _____ ADDRESS: _____
 CITY: _____ STATE: _____ ZIP: _____ IS THIS A NEW ADDRESS ..

NAME: _____ ADDRESS: _____
 CITY: _____ STATE: _____ ZIP: _____ IS THIS A NEW ADDRESS ..

<p>FOR BLM USE ONLY</p> <p>DATE ENTERED INTO COMPUTER: _____</p> <p>INITIALS: _____ VERIFIED: _____</p>

January 30, 2003

United States Department of the Interior
Bureau of Land Management
 BUSINESS & SUPPORT SVCS DIV
 222 N CENTRAL AVE
 PHOENIX, AZ 85004 -2203
 Phone: (602) 417-9200

Receipt

No:

935097

Transaction #: 969412**Date of Transaction:** 08/23/2004

CUSTOMER: THOMAS J SMALL
 361 E KANIKSU ST
 APACHE JUNCTION, AZ 85219

LINE #	QTY	DESCRIPTION	REMARKS	UNIT PRICE	TOTAL
1	1.00	LOCATABLE MINERALS / MINING CLAIMS-NOT NEW-UNADJUD, ONE AUTH NO. ONLY / MINING CLAIM MONEY RECEIVED (455) CASES: AMC353995/\$1875.00	MAINT 2005 (16)	- n/a -	1875.00
TOTAL:					\$1,875.00

PAYMENT INFORMATION

NOTE: Items will appear on credit card statement as "Bureau of Land Management".

1	AMOUNT:	\$1,875.00	POSTMARKED:	N/A
	TYPE:	CREDIT CARD	RECEIVED:	08/23/2004
	NAME:	SMALL, THOMAS J 361 E KANIKSU ST APACHE JUNCTION AZ 85219		
	CARD NO:	XXXXXXXXXXXX9259	AUTH CODE:	293265
	NAME ON CARD:	THOMAS J SMALL		
	EXPIRES:	07/31/2006		
	SIGNATURE:			

REMARKS

This receipt was generated by the automated BLM Collections and Billing System and is a paper representation of a portion of the official electronic record contained therein.

AMC 352009
 AMC 350201
 AMC 350296
 AMC 349578
 AMC 353995
 AMC 330410

17 x 100.⁰⁰ = 1700.⁰⁰
 TES

MAINTENANCE FEE PAYMENT

Mining Claim Maintenance Fee Payment of \$100 per claim or site is due on or before September 1, 20____, in lieu of assessment work for the upcoming assessment year beginning September 1 of the year noted above.

BUREAU OF LAND MANAGEMENT
 ARIZONA STATE OFFICE
 222 NORTH CENTRAL AVENUE
 PHOENIX, AZ 85004
 602-417-9200
 www.az.blm.gov

FOR BLM USE ONLY
 NO. OF CLAIMS: _____ X \$100 = \$ _____
 RECEIPT NO: 798605 CHECK NO: _____
 INIT: _____

BLM SERIAL NUMBERS	NAME OF CLAIMS/SITES	COUNTY BOOK/DOCKET & PAGE OR FEE NUMBER
✓ 1. AMC <u>330410</u>	<u>Rocking Horse # 1</u>	<u>94-0341304</u>
✓ 2. AMC <u>353995</u>	<u>" " # 2</u>	<u>2000-0470802</u>
3. AMC <u>349578</u>	<u>" " # 4</u>	<u>98-0082685</u>
4. AMC <u>349579</u>	<u>" " # 5</u>	<u>98-0082683</u>
5. AMC <u>349580</u>	<u>" " # 6</u>	<u>98-0082684</u>
✓ 6. AMC <u>353996</u>	<u>" " # 8</u>	<u>2000-0470800</u>
7. AMC <u>350296</u>	<u>" " # 14</u>	<u>98-0503702</u>
8. AMC <u>350201</u>	<u>" " # 17</u>	<u>98-0180989</u>
9. AMC <u>350202</u>	<u>" " # 18</u>	<u>98-0180988</u>
10. AMC <u>352011</u>	<u>" " # 19</u>	<u>99-0057320</u>

List additional claims on the reverse side of this form.

CHECK HERE IF THIS IS A CHANGE OF ADDRESS

CLAIMANT'S NAME: THOMAS F. SMALL

ADDRESS: 361 E. KAVIKSU ST.

CITY: APACHE JUNCTION STATE: AZ ZIP: 85219

PHONE: 480-671-1053

Signature: Thomas F. Small

To record with the County, one claimant or an agent must sign.

TES
 9/26/03
 ENTERED INTO COMPUTER

PHOENIX, ARIZONA
 2003 AUG 26 11:00
 BLM DATE STAMP
 BLM ARIZONA STATE OFFICE
 RECEIVED

TES

11. AMC	<u>350297</u>	<u>Rocking Horse # 39</u>	<u>98-0503703</u>
12. AMC	<u>352012</u>	<u>" " # 54</u>	<u>99-0057315</u>
13. AMC	<u>352013</u>	<u>" " # 55</u>	<u>99-0057319</u>
14. AMC	<u>352014</u>	<u>" " # 56</u>	<u>99-0061273</u>
15. AMC	<u>350439</u>	<u>" " # 3</u>	<u>99-0988270</u> <u>99-0988271</u>
16. AMC	<u>349593</u>	<u>" " # 103</u>	<u>97-0832755</u>
17. AMC	<u>349594</u>	<u>" " # 104</u>	<u>97-0832756</u>
18. AMC	_____	_____	_____
19. AMC	_____	_____	_____
20. AMC	_____	_____	_____

43 CFR 3833.0-5(e) (August 30, 1994) requires that the names of all of the owners and their current addresses shall be identified on all instruments required to be recorded or filed by the regulation, 43 CFR Subpart 3833.

NAME: _____ ADDRESS: _____

CITY: _____ STATE: _____ ZIP: _____ IS THIS A NEW ADDRESS ..

NAME: _____ ADDRESS: _____

CITY: _____ STATE: _____ ZIP: _____ IS THIS A NEW ADDRESS ..

NAME: _____ ADDRESS: _____

CITY: _____ STATE: _____ ZIP: _____ IS THIS A NEW ADDRESS ..

NAME: _____ ADDRESS: _____

CITY: _____ STATE: _____ ZIP: _____ IS THIS A NEW ADDRESS ..

January 30, 2003

FOR BLM USE ONLY	
DATE ENTERED INTO COMPUTER:	_____
INITIALS:	_____ VERIFIED: _____

United States Department of the Interior
Bureau of Land Management
 BUSINESS & SUPPORT SVCS DIV
 222 N CENTRAL AVE
 PHOENIX, AZ 85004 -2203
 Phone: (602) 417-9200

Receipt	
No:	738605

Transaction #: 768128
Date of Transaction: 08/26/2003
CUSTOMER: THOMAS J SMALL 361 E KANIKSU ST APACHE JUNCTION, AZ 85219

LINE #	QTY	DESCRIPTION	REMARKS	UNIT PRICE	TOTAL
1	1.00	LOCATABLE MINERALS / MINING CLAIMS-NOT NEW-UNADJUD, ONE AUTH NO. ONLY / MINING CLAIM MONEY RECEIVED (455) CASES: AMC330410/\$1700.00	MAIN 2004 (17)	- n/a -	1700.00
TOTAL:					\$1,700.00

PAYMENT INFORMATION			
NOTE: Items will appear on credit card statement as "Bureau of Land Management".			
1	AMOUNT:	\$1,700.00	POSTMARKED: N/A
	TYPE:	CREDIT CARD	RECEIVED: 08/26/2003
	NAME:	SMALL, THOMAS J 361 E KANIKSU ST APACHE JUNCTION AZ 85219	
	CARD NO:	XXXXXXXXXXXX9259	AUTH CODE: 293285
	NAME ON CARD:	SMALL/THOMAS J	
	EXPIRES:	07/31/2004	
	SIGNATURE:		

REMARKS

This receipt was generated by the automated BLM Collections and Billing System and is a paper representation of a portion of the official electronic record contained therein.

Receipt No. 539795

Trans No. 564283

LEAD FILE #'S _____

AMC 350201, 349578
350296, 350437, 352009, 352009
330410, 353995

AMC Number	Code	Amount
349593-349594	482	200.00
349603-349604		200.00
350297-350298		200.00
350439		100.00
352011-352015		500.00
349578-349580		300.00
350201-350202		200.00
350296		100.00
352009-352010		200.00
330410		100.00
353995-353996		200.00
353998		100.00
TOTAL:	<u>482</u>	\$ <u>2400.00</u>

AMC Number	Code	Amount
TOTAL:		\$

Date of Doc 8/13/02
Date of Rec't 8/13/02
Amount Rec'd 2400.00
Amount Earned 2,400.00

Date Entered: 9/13/02
Date Verified: 9/16/02 AB
Sent to Accts: " "
Date Earned: _____

- 480 POL
- 481 NOI
- 482 MAINT
- 396 TRANS
- 635 AMEND

NOTES:

MAINTENANCE FEE PAYMENT

\$100.00 MAINTENANCE FEE PAYMENT DUE ON OR BEFORE SEPTEMBER 01, 20____
 IN LIEU OF ASSESSMENT WORK FOR THE UPCOMING ASSESSMENT
 YEAR BEGINNING SEPTEMBER 1 OF THE YEAR NOTED ABOVE.

BUREAU OF LAND MANAGEMENT
 ARIZONA STATE OFFICE
 222 NORTH CENTRAL AVENUE
 PHOENIX, AZ 85004-2003

COUNT: _____ \$ _____ INT: _____
 FOR OFFICIAL USE ONLY

THE CLAIMS ARE SITUATED IN MARICOPA COUNTY, ARIZONA.

BLM SERIAL NUMBERS NAMES OF CLAIMS OR SITES

A MC _____ THRU A MC _____
 COUNTY BOOK/DOCKET _____, PAGE(S) OR FEE NO(S) _____

A MC _____ THRU A MC _____
 COUNTY BOOK/DOCKET _____, PAGE(S) OR FEE NO(S) _____

(OR) IF NOT CONSECUTIVE NUMBERS LIST SEPARATELY BELOW:

BLM SERIAL NUMBERS	NAME OF CLAIMS/SITES	COUNTY BOOK/DOCKET & PAGE OR FEE NUMBER
A MC <u>330410</u>	<u>ROCKING HORSE #1</u>	<u>94-0341304</u>
A MC <u>353995</u>	<u>ROCKING HORSE #2</u>	<u>2000-0470802</u>
A MC <u>349578</u>	<u>ROCKING HORSE #4</u>	<u>98-0082685</u>
A MC <u>349579</u>	<u>ROCKING HORSE #5</u>	<u>98-0082683</u>
A MC <u>349580</u>	<u>ROCKING HORSE #6</u>	<u>98-0082684</u>
A MC <u>353996</u>	<u>ROCKING HORSE #8</u>	<u>2000-0470800</u>
A MC <u>352009</u>	<u>ROCKING HORSE #9</u>	<u>99-0057316</u>
A MC <u>353998</u>	<u>ROCKING HORSE #11</u>	<u>2000-0470801</u>
A MC <u>352010</u>	<u>ROCKING HORSE #12</u>	<u>99-0057317</u>
A MC <u>350296</u>	<u>ROCKING HORSE #14</u>	<u>98-0503702</u>
A MC <u>350201</u>	<u>ROCKING HORSE #17</u>	<u>98-0180989</u>
A MC <u>350202</u>	<u>ROCKING HORSE #18</u>	<u>98-0180988</u>

CLAIMANT'S NAME: THOMAS F. SMALL

ADDRESS: 361 E. KARUKSU ST. CITY: APACHE JCT. STATE: AZ

CHECK HERE IF THIS IS A CHANGE OF ADDRESS PHONE: (480) 671-1053 ZIP: 85219

SIGNATURE: _____
 TO RECORD WITH THE COUNTY, ONE CLAIMANT OR THE AGENT MUST SIGN

LIST ALL ADDITIONAL OWNERS ON REVERSE SIDE OF THIS FORM

FOR OFFICIAL USE ONLY

ENTERED INTO COMPUTER: 9/13/02 JK
 DATE INITIALS VERIFIED

RECEIVED
 B.L.M. AZ STATE OFFICE
 2002 AUG 13 P 3:39
 PHOENIX

MAINTENANCE FEE PAYMENT

\$100.00 MAINTENANCE FEE PAYMENT DUE ON OR BEFORE SEPTEMBER 01, 20____
 IN LIEU OF ASSESSMENT WORK FOR THE UPCOMING ASSESSMENT
 YEAR BEGINNING SEPTEMBER 1 OF THE YEAR NOTED ABOVE.

BUREAU OF LAND MANAGEMENT
 ARIZONA STATE OFFICE
 222 NORTH CENTRAL AVENUE
 PHOENIX, AZ 85004-2003

COUNT: 24 \$ 2,400 INT: 700
 FOR OFFICIAL USE ONLY

THE CLAIMS ARE SITUATED IN Maricopa COUNTY, ARIZONA.

BLM SERIAL NUMBERS _____ NAMES OF CLAIMS OR SITES _____
 A MC _____ THRU A MC _____
 COUNTY BOOK/DOCKET _____, PAGE(S) OR FEE NO(S) _____
 A MC _____ THRU A MC _____
 COUNTY BOOK/DOCKET _____, PAGE(S) OR FEE NO(S) _____

(OR) IF NOT CONSECUTIVE NUMBERS LIST SEPARATELY BELOW:

BLM SERIAL NUMBERS	NAME OF CLAIMS/SITES	COUNTY BOOK/DOCKET & PAGE OR FEE NUMBER
A MC <u>352011</u>	<u>Rocking Horse # 19</u>	<u>99-0057320</u>
A MC <u>350297</u>	<u>Rocking Horse # 39</u>	<u>98-0503703</u>
A MC <u>350298</u>	<u>Rocking Horse # 53</u>	<u>98-0503704</u>
A MC <u>352012</u>	<u>Rocking Horse # 54</u>	<u>99-0057315</u>
A MC <u>352013</u>	<u>Rocking Horse # 55</u>	<u>99-0057319</u>
A MC <u>352014</u>	<u>Rocking Horse # 56</u>	<u>99-0061273</u>
A MC <u>352015</u>	<u>Rocking Horse # 57</u>	<u>99-0057318</u>
A MC <u>350439</u>	<u>Rocking Horse # 3</u>	<u>99-0988270</u> <u>99-0988271</u>
A MC <u>349593</u>	<u>Rocking Horse # 103</u>	<u>97-0832755</u>
A MC <u>349594</u>	<u>Rocking Horse # 104</u>	<u>97-0832756</u>
A MC <u>349603</u>	<u>Rocking Horse # 113</u>	<u>97-0832765</u>
A MC <u>349604</u>	<u>Rocking Horse # 114</u>	<u>97-0832766</u>

CLAIMANT'S NAME: THOMAS J. SMALL

ADDRESS: 361 E. KAWIKSU ST. CITY: APACHE JCT. STATE: AZ

CHECK HERE IF THIS IS A CHANGE OF ADDRESS PHONE: (480) 671-1053 ZIP: 85219

SIGNATURE: _____
 TO RECORD WITH THE COUNTY, ONE CLAIMANT OR THE AGENT MUST SIGN

LIST ALL ADDITIONAL OWNERS ON REVERSE SIDE OF THIS FORM

FOR OFFICIAL USE ONLY
 ENTERED INTO COMPUTER: 9/13/02 TK
 DATE INITIALS VERIFIED

TIME STAMP
 PHOENIX, ARIZONA
 2002 AUG 13 P 3: 38
 RECEIVED
 B.L.M. AZ STATE OFFICE

United States Department of the Interior
Bureau of Land Management
 BUSINESS & SUPPORT SVCS DIV
 222 N CENTRAL AVE
 PHOENIX, AZ 85004 -2203
 Phone: (602) 417-9200

Receipt	
No:	539795

Transaction #: 564283
Date of Transaction: 08/13/2002
CUSTOMER: THOMAS J SMALL 361 E KANIKSU ST APACHE JUNCTION, AZ 85219

LINE #	QTY	DESCRIPTION	REMARKS	UNIT PRICE	TOTAL
1	1.00	LOCATABLE MINERALS / MINING CLAIMS-NOT NEW-UNADJUD,ONE AUTH NO. ONLY / MINING CLAIM MONEY RECEIVED (455) CASES: AMC352011/\$2400.00	MAINT 2003 (24)	- n/a -	2400.00
TOTAL:					\$2,400.00

PAYMENT INFORMATION			
NOTE: Items will appear on credit card statement as "Bureau of Land Management".			
1	AMOUNT:	\$2,400.00	POSTMARKED: N/A
	TYPE:	CREDIT CARD	RECEIVED: 08/13/2002
	NAME:	SMALL, THOMAS J 361 E KANIKSU ST APACHE JUNCTION AZ 85219	
	CARD NO:	XXXXXXXXXXXX7574	AUTH CODE: 272557
	NAME ON CARD:	SMALL/THOMAS J	
	EXPIRES:	07/31/2004	
	SIGNATURE:		

REMARKS

This receipt was generated by the automated BLM Collections and Billing System and is a paper representation of a portion of the official electronic record contained therein.

Receipt No. 368688

LEAD FILE #'S _____

Trans No. 387365

AMC 330410 ; AMC 349578 ; AMC 35020

AMC 350296 ; AMC 350437 ; AMC 352009

AMC 353995 AMC 350201

AMC Number	Code	Amount
330410	482	100 ⁰⁰
349578 - 349580	}	300 ⁰⁰
349593 - 349594		200 ⁰⁰
349603 - 349604		200 ⁰⁰
350201 - 350202		200 ⁰⁰
350296 - 350298		300 ⁰⁰
350298 350439		100 ⁰⁰
352009 - 352015		700 ⁰⁰
353995 - 353999	500 ⁰⁰	
TOTAL:		\$2600 ⁰⁰

AMC Number	Code	Amount
TOTAL:		\$

Date of Doc _____

Date Entered: 10/25/2001 RE

Date of Rec't _____

Date Verified: _____

Amount Rec'd \$2600.00

Sent to Accts: _____

Amount Earned \$2600.00

Date Earned: _____

- 480 POL
- 481 NOI
- 482 MAINT
- 396 TRANS
- 635 AMEND

NOTES:

MAINTENANCE FEE PAYMENT

\$100.00 MAINTENANCE FEE PAYMENT DUE ON OR BEFORE SEPTEMBER 01, 2001
 IN LIEU OF ASSESSMENT WORK FOR THE UPCOMING ASSESSMENT
 YEAR BEGINNING SEPTEMBER 1 OF THE YEAR NOTED ABOVE.

BUREAU OF LAND MANAGEMENT
 ARIZONA STATE OFFICE
 222 NORTH CENTRAL AVENUE
 PHOENIX, AZ 85004-2003

COUNT: 26 \$ 2600.00 INT: R
 FOR OFFICIAL USE ONLY

365655

THE CLAIMS ARE SITUATED IN MARICOPA COUNTY, ARIZONA.

BLM SERIAL NUMBERS _____ NAMES OF CLAIMS OR SITES _____
 A MC _____ THRU A MC _____
 COUNTY BOOK/DOCKET _____, PAGE(S) OR FEE NO(S) _____
 A MC _____ THRU A MC _____
 COUNTY BOOK/DOCKET _____, PAGE(S) OR FEE NO(S) _____

(OR) IF NOT CONSECUTIVE NUMBERS LIST SEPARATELY BELOW:

BLM SERIAL NUMBERS	NAME OF CLAIMS/SITES	COUNTY BOOK/DOCKET & PAGE OR FEE NUMBER
- A MC <u>330410</u>	<u>Rocking Horse #1</u>	
- A MC <u>353995</u>	<u>Rocking Horse #2</u>	
- A MC <u>350439</u>	<u>Rocking Horse #3</u>	
- A MC <u>349578</u>	<u>Rocking Horse #4</u>	
- A MC <u>349579</u>	<u>Rocking Horse #5</u>	
- A MC <u>349580</u>	<u>Rocking Horse #6</u>	
- A MC <u>353996</u>	<u>Rocking Horse #8</u>	
- A MC <u>352009</u>	<u>Rocking Horse #9</u>	
- A MC <u>353997</u>	<u>Rocking Horse #10</u>	
- A MC <u>353998</u>	<u>Rocking Horse #11</u>	
- A MC <u>352010</u>	<u>Rocking Horse #12</u>	
- A MC <u>353999</u>	<u>Rocking Horse #13</u>	

CLAIMANT'S NAME: THOMAS T. SMALL

ADDRESS: 361 E. KAUKSU ST. CITY: ARIZONA STATE: AZ

CHECK HERE IF THIS IS A CHANGE OF ADDRESS PHONE: (480) 671-1053 ZIP: 85219

SIGNATURE: _____
 TO RECORD WITH THE COUNTY, ONE CLAIMANT OR THE AGENT MUST SIGN

LIST ALL ADDITIONAL OWNERS ON REVERSE SIDE OF THIS FORM

FOR OFFICIAL USE ONLY
 ENTERED INTO COMPUTER: 10/25/2001 DATE INITIALS RWS VERIFIED

ARIZONA
 TIME STAMP
 11 3: 29 P 2001 AUG 29
 RECEIVED
 B.L.M. STATE OFFICE

43 CFR 3833.0-5(c) (August 30, 1994) REQUIRES THAT THE NAMES OF ALL OF THE OWNERS AND THEIR CURRENT ADDRESSES SHALL BE IDENTIFIED ON ALL INSTRUMENTS REQUIRED TO BE RECORDED OR FILED BY THE REGULATIONS, 43 CFR SUBPART 3833.

CLAIMANT'S NAME: _____
ADDRESS: _____ CITY: _____ STATE: _____
 CHECK HERE IF THIS PHONE: () _____ ZIP: _____ IS
CHANGE OF ADDRESS

CLAIMANT'S NAME _____
ADDRESS _____ CITY: _____ STATE: _____
 CHECK HERE IF THIS PHONE: () _____ ZIP: _____ IS
CHANGE OF ADDRESS

CLAIMANT'S NAME _____
ADDRESS _____ CITY: _____ STATE: _____
 CHECK HERE IF THIS PHONE () _____ ZIP _____ IS
CHANGE OF ADDRESS

CLAIMANT'S NAME _____
ADDRESS _____ CITY: _____ STATE: _____
 CHECK HERE IF THIS PHONE () _____ ZIP _____ IS
CHANGE OF ADDRESS

CLAIMANT'S NAME _____
ADDRESS _____ CITY: _____ STATE: _____
 CHECK HERE IF THIS PHONE () _____ ZIP _____ IS
CHANGE OF ADDRESS

CLAIMANT'S NAME _____
ADDRESS _____ CITY: _____ STATE: _____
 CHECK HERE IF THIS PHONE: () _____ ZIP: _____ IS
CHANGE OF ADDRESS

CLAIMANT'S NAME: _____
ADDRESS _____ CITY: _____ STATE: _____
 CHECK HERE IF THIS PHONE: () _____ ZIP: _____ IS
CHANGE OF ADDRESS

CLAIMANT'S NAME _____
ADDRESS _____ CITY: _____ STATE _____
 CHECK HERE IF THIS PHONE () _____ ZIP: _____ IS
CHANGE OF ADDRESS

**MINING CLAIM, MILL SITE OR TUNNEL SITE
MAINTENANCE FEE PAYMENT CONTINUATION SHEET**

BLM SERIAL NUMBERS	NAME OF CLAIMS/SITES	COUNTY BOOK/DOCKET & PAGE OR FEE NUMBER
/ A MC <u>350296</u>	<u>Rocking Horse # 14</u>	
/ A MC <u>350201</u>	<u>Rocking Horse # 17</u>	
/ A MC <u>350202</u>	<u>Rocking Horse # 18</u>	
/ A MC <u>350297</u>	<u>Rocking Horse # 39</u>	
/ A MC <u>352011</u>	<u>Rocking Horse # 19</u>	
/ A MC <u>350298</u>	<u>Rocking Horse # 53</u>	
/ A MC <u>352012</u>	<u>Rocking Horse # 54</u>	
/ A MC <u>352013</u>	<u>Rocking Horse # 55</u>	
/ A MC <u>352014</u>	<u>Rocking Horse # 56</u>	
/ A MC <u>352015</u>	<u>Rocking Horse # 57</u>	
/ A MC <u>349593</u>	<u>Rocking Horse # 103</u>	
/ A MC <u>349594</u>	<u>Rocking Horse # 104</u>	
A MC 349595	Rocking Horse # <u>VOID T.S.</u>	
/ A MC <u>349603</u>	<u>Rocking Horse # 113</u>	
/ A MC <u>349604</u>	<u>Rocking Horse # 114</u>	
A MC _____	_____	_____
A MC _____	_____	_____
A MC _____	_____	_____
A MC _____	_____	_____
A MC _____	_____	_____
A MC _____	_____	_____
A MC _____	_____	_____
A MC _____	_____	_____
A MC _____	_____	_____
A MC _____	_____	_____
A MC _____	_____	_____
A MC _____	_____	_____

FOR OFFICIAL USE ONLY		
ENTERED INTO COMPUTER:	<u>10/25/2001</u>	<u>WOS</u>
	DATE	INITIALS
		VERIFIED

TIME STAMP
 PHOENIX, ARIZONA
 2001 AUG 29 P 3:41
 RECEIVED
 BLM STATE OFFICE

**United States Department of the Interior
Bureau of Land Management
BUSINESS & SUPPORT SVCS DIV
222 N CENTRAL AVE
PHOENIX, AZ 85004 -2203
Phone: (602) 417-9200**

Receipt	
No:	368688

Transaction #: 387365
Date of Transaction: 08/29/2001

CUSTOMER: THOMAS J SMALL
361 E. KANIKSU ST
APACHE JUNCTION, AZ 85219

LINE #	QTY	COMMODITY / SUBJECT / ACTION / PRODUCT	REMARKS	UNIT PRICE	TOTAL
1	1.00	LOCATABLE MINERALS / MINING CLAIMS-NOT NEW-UNADJUD, ONE AUTH NO. ONLY / MINING CLAIM MONEY RECEIVED (455)	MAIN FEES 2002 (26)	- n/a -	\$2,600.00
TOTAL:					\$2,600.00

PAYMENT INFORMATION			
1	AMOUNT:	\$2,600.00	POSTMARKED: N/A
	TYPE:	CREDIT CARD	RECEIVED: 08/29/2001
	NAME:	SMALL, THOMAS J 361 E. KANIKSU ST APACHE JUNCTION AZ 85219	
	CARD NO:	XXXXXXXXXXXX7574	AUTH CODE: 274517
	NAME ON CARD:	SMALL/THOMAS J	
	EXPIRES:	07/31/2002	
	SIGNATURE:		

REMARKS

CASE SERIAL NUMBER INFORMATION		
TRNS #	LINE #	CASES
387365	1	AMC330410/\$2600.00

This receipt was generated by the automated BLM Collections and Billings System and is a paper representation of a portion of the official electronic record contained therein.

Receipt #: 165 418

Lead #: 330410 - 349346 - 349578

Amount Received: 6000.00

350201 - 350296 - 350437

Date: 8/9/00

352009

Transaction #: 178671

AMC #	Code	\$\$\$\$
330410	482	100.-
349346-349348	}	300.-
349578-349 580 ⁶²⁰		4300.-
350201-350202		200.-
350296-350298		300.-
350439		100.-
352009-352015		700.-

AMC #	Code	\$\$\$\$

Total: 6,000.00

- 480----POL-----\$5
- 481----NOI-----\$5
- 482----Maint.----\$100
- 396----Trf.-----\$5
- 635----Amd.-----\$5
- 379----Refund

Entered: [Signature] 8-11-00
Date

Verified: [Signature] 15 AUG 2000
Date

Sent to Accounts: [Signature] 15 AUG 2000
Date

Earned by Accounts: _____
Date

MAINTENANCE FEE PAYMENT

\$100.00 MAINTENANCE FEE PAYMENT DUE ON OR BEFORE SEP 01 2000
 IN LIEU OF ASSESSMENT WORK FOR THE UPCOMING ASSESSMENT
 YEAR BEGINNING SEPTEMBER 1 OF THE YEAR NOTED ABOVE.

Bureau Of Land Management
 Arizona State Office
 222 North Central Avenue
 Phoenix, AZ. 85004-2203

COUNT: 50 \$ 5000.00 INT: ES
 FOR OFFICIAL USE ONLY

THE CLAIMS ARE SITUATED IN MARICOPA COUNTY,
 ARIZONA.

BLM SERIAL NUMBERS NAMES OF CLAIMS OR SITES

A MC 349581 THRU A MC 349620 ROCKING HORSE #91 THRU #130

COUNTY BOOK/DOCKET _____, PAGE(S) OR FEE NO(S) _____

A MC _____ THRU A MC _____

COUNTY BOOK/DOCKET _____, PAGE(S) OR FEE NO(S) _____

(OR) IF NOT CONSECUTIVE NUMBERS LIST SEPARATELY BELOW:

BLM SERIAL NUMBERS	NAME OF CLAIMS/SITES	COUNTY BOOK/DOCKET & PAGE OR FEE NUMBER
A MC <u>330410</u>	<u>ROCKING HORSE #1</u>	_____
A MC <u>350439</u>	" " <u>#3</u>	_____
A MC <u>349578</u>	" " <u>#4</u>	_____
A MC <u>349579</u>	" " <u>#5</u>	_____
A MC <u>349580</u>	" " <u>#6</u>	_____
A MC <u>349346</u>	" " <u>#7</u>	_____
A MC <u>352009</u>	" " <u>#9</u>	_____
A MC <u>352010</u>	" " <u>#12</u>	_____
A MC <u>350296</u>	" " <u>#14</u>	_____
A MC <u>350201</u>	" " <u>#17</u>	_____

CLAIMANT'S NAME: THOMAS J. SMALL

ADDRESS: 361 E. KARIBSU ST. CITY: AVAZO STATE: AZ

CHECK HERE IF THIS IS A CHANGE OF ADDRESS PHONE: (480) 671-1053 ZIP: 85219

SIGNATURE: Thomas J. Small
 TO RECORD WITH THE COUNTY, ONE CLAIMANT OR THE AGENT MUST SIGN

LIST ALL ADDITIONAL OWNERS ON REVERSE SIDE OF THIS FORM

FOR OFFICIAL USE ONLY

ENTERED INTO COMPUTER: 8-11-00 Sc

RECEIVED
 BLM AZ STATE OFFICE
 2000 AUG -9 P 12:56
 PHOENIX ARIZONA

43 CFR 3833.0-5(e) (August 30, 1994) REQUIRES THAT THE NAMES OF ALL OF THE OWNERS AND THEIR CURRENT ADDRESSES SHALL BE IDENTIFIED ON ALL INSTRUMENTS REQUIRED TO BE RECORDED OR FILED BY THE REGULATIONS, 43 CFR SUBPART 3833.

CLAIMANT'S NAME: _____

ADDRESS: _____ CITY: _____ STATE: _____

CHECK HERE IF THIS IS CHANGE OF ADDRESS PHONE: () _____ ZIP: _____

CLAIMANT'S NAME: _____

ADDRESS: _____ CITY: _____ STATE: _____

CHECK HERE IF THIS IS CHANGE OF ADDRESS PHONE: () _____ ZIP: _____

CLAIMANT'S NAME: _____

ADDRESS: _____ CITY: _____ STATE: _____

CHECK HERE IF THIS IS CHANGE OF ADDRESS PHONE: () _____ ZIP: _____

CLAIMANT'S NAME: _____

ADDRESS: _____ CITY: _____ STATE: _____

CHECK HERE IF THIS IS CHANGE OF ADDRESS PHONE: () _____ ZIP: _____

CLAIMANT'S NAME: _____

ADDRESS: _____ CITY: _____ STATE: _____

CHECK HERE IF THIS IS CHANGE OF ADDRESS PHONE: () _____ ZIP: _____

CLAIMANT'S NAME: _____

ADDRESS: _____ CITY: _____ STATE: _____

CHECK HERE IF THIS IS CHANGE OF ADDRESS PHONE: () _____ ZIP: _____

CLAIMANT'S NAME: _____

ADDRESS: _____ CITY: _____ STATE: _____

CHECK HERE IF THIS IS CHANGE OF ADDRESS PHONE: () _____ ZIP: _____

MAINTENANCE FEE PAYMENT

\$100.00 MAINTENANCE FEE PAYMENT DUE ON OR BEFORE SEP 01 2000
 IN LIEU OF ASSESSMENT WORK FOR THE UPCOMING ASSESSMENT
 YEAR BEGINNING SEPTEMBER 1 OF THE YEAR NOTED ABOVE.

Bureau Of Land Management
 Arizona State Office
 222 North Central Avenue
 Phoenix, AZ. 85004-2203

COUNT: 10 \$ 1000.⁰⁰ INT: EB
 FOR OFFICIAL USE ONLY

THE CLAIMS ARE SITUATED IN MARICOPA COUNTY,
 ARIZONA.

BLM SERIAL NUMBERS NAMES OF CLAIMS OR SITES

A MC _____ THRU A MC _____

COUNTY BOOK/DOCKET _____, PAGE(S) OR FEE NO(S) _____

A MC _____ THRU A MC _____

COUNTY BOOK/DOCKET _____, PAGE(S) OR FEE NO(S) _____

(OR) IF NOT CONSECUTIVE NUMBERS LIST SEPARATELY BELOW:

BLM SERIAL NUMBERS	NAME OF CLAIMS/SITES	COUNTY BOOK/DOCKET & PAGE OR FEE NUMBER
A MC <u>350202</u>	<u>ROCKING HORSE # 18</u>	_____
A MC <u>352011</u>	<u>" " # 19</u>	_____
A MC <u>350297</u>	<u>" " # 39</u>	_____
A MC <u>350298</u>	<u>" " # 53</u>	_____
A MC <u>352012</u>	<u>" " # 54</u>	_____
A MC <u>352013</u>	<u>" " # 55</u>	_____
A MC <u>352014</u>	<u>" " # 56</u>	_____
A MC <u>352015</u>	<u>" " # 57</u>	_____
A MC <u>349347</u>	<u>" " # 80</u>	_____
A MC <u>349348</u>	<u>" " # 88</u>	_____

CLAIMANT'S NAME: THOMAS J. SMALL

ADDRESS: 3101 E. KARUKSU ST. CITY: APACHE JCT. STATE: AZ

CHECK HERE IF THIS IS A CHANGE OF ADDRESS PHONE: (480) 671-1053 ZIP: 85219

SIGNATURE: Thomas J. Small
 TO RECORD WITH THE COUNTY, ONE CLAIMANT OR THE AGENT MUST SIGN

LIST ALL ADDITIONAL OWNERS ON REVERSE SIDE OF THIS FORM

FOR OFFICIAL USE ONLY

ENTERED INTO COMPUTER: 8/10/00 slc 15 AUG 2000

TIME STAMP
 PHOENIX, ARIZONA

2000 AUG -9 P 12:56

BLM STATE OFFICE

43 CFR 3833.0-5(e) (August 30, 1994) REQUIRES THAT THE NAMES OF ALL OF THE OWNERS AND THEIR CURRENT ADDRESSES SHALL BE IDENTIFIED ON ALL INSTRUMENTS REQUIRED TO BE RECORDED OR FILED BY THE REGULATIONS, 43 CFR SUBPART 3833.

CLAIMANT'S NAME: _____

ADDRESS: _____ CITY: _____ STATE: _____

CHECK HERE IF THIS IS CHANGE OF ADDRESS PHONE: () ZIP: _____

CLAIMANT'S NAME: _____

ADDRESS: _____ CITY: _____ STATE: _____

CHECK HERE IF THIS IS CHANGE OF ADDRESS PHONE: () ZIP: _____

CLAIMANT'S NAME: _____

ADDRESS: _____ CITY: _____ STATE: _____

CHECK HERE IF THIS IS CHANGE OF ADDRESS PHONE: () ZIP: _____

CLAIMANT'S NAME: _____

ADDRESS: _____ CITY: _____ STATE: _____

CHECK HERE IF THIS IS CHANGE OF ADDRESS PHONE: () ZIP: _____

CLAIMANT'S NAME: _____

ADDRESS: _____ CITY: _____ STATE: _____

CHECK HERE IF THIS IS CHANGE OF ADDRESS PHONE: () ZIP: _____

CLAIMANT'S NAME: _____

ADDRESS: _____ CITY: _____ STATE: _____

CHECK HERE IF THIS IS CHANGE OF ADDRESS PHONE: () ZIP: _____

CLAIMANT'S NAME: _____

ADDRESS: _____ CITY: _____ STATE: _____

CHECK HERE IF THIS IS CHANGE OF ADDRESS PHONE: () ZIP: _____

United States Department of the Interior
Bureau of Land Management
 BUSINESS & SUPPORT SVCS DIV
 222 N CENTRAL AVE
 PHOENIX, AZ 85004 -2203
 Phone: (602) 417-9200

Receipt	
No:	165618

Transaction #: 178671					
Date of Transaction: 08/09/2000					
CUSTOMER: THOMAS J SMALL 361 E. KANIKSU ST APACHE JUNCTION, AZ 85219					
LINE #	QTY	COMMODITY / SUBJECT / ACTION / PRODUCT	REMARKS	UNIT PRICE	TOTAL
1	1	LOCATABLE MINERALS / MINING CLAIMS-ACCOUNTS/UNADJUDICATED / MINING CLAIM MONEY RECEIVED (455)	MAINT 2001 (60)	- n/a -	\$6,000.00
TOTAL:					\$6,000.00

PAYMENT INFORMATION			
1	AMOUNT:	\$6,000.00	POSTMARKED: N/A
	TYPE:	CREDIT CARD	RECEIVED: 08/09/2000
	NAME:	SMALL, THOMAS J 361 E. KANIKSU ST APACHE JUNCTION AZ 85219	
	CARD NO:	XXXXXXXXXXXX7574	AUTH CODE: 272527
	NAME ON CARD:	SMALL/THOMAS J	
	EXPIRES:	07/31/2002	
	SIGNATURE:		

REMARKS

CASE SERIAL NUMBER INFORMATION		
TRNS #	LINE #	CASES
178671	1	AMC330410

This receipt was generated by the automated BLM Collections and Billings System and is a paper representation of a portion of the official electronic record contained therein.

MAINTENANCE FEE PAYMENT WAIVER CERTIFICATION

This small miner waiver is filed to hold the claims/sites listed below for the assessment year beginning at noon on the first September 1 following the official filing of this form with BLM.

The undersigned owner(s) of the mining claims/sites listed below hereby certify under penalty of 18 U.S.C. 1001 and 43 U.S.C. 1212 that:

I/We control, or will control, ten or fewer mining claims/sites located and maintained on Federal land in the United States of America on the August 31 that is one day before the beginning of the assessment year indicated in line one above.

I/We have/will performed/perform assessment work upon the claims listed below for the current assessment year as of the August 31 indicated in line three above. This work meets the requirements of the General Mining Law of 1872, as amended; the Act of August 10, 1993; and the regulations at 43 CFR 3833 and 3850. Such work will be described on our affidavit of labor.

The mining claims and sites for which the above waiver from payment of the maintenance fees is made are:

	CLAIM NAME	BLM RECORDATION SERIAL NUMBER
1.	BEARCAT #1 Sec. 33 - TAN - R20W	327533
2.	BEARCAT #2 28 -	327534
3.	CACTUS 28	327535
4.	CACTUS #1 28	327536
5.	CACTUS #2 28	327537
6.	CACTUS #3 28	327538
7.	CACTUS #4 33	327539
8.	CACTUS #6 28	327540
9.	CACTUS #7 33	327541
10.	GOLDWOOD 28	349802

All owner(s) of the above mining claims and sites are filing for this waiver.

I/We understand and acknowledge that pursuant to 43 U.S.C. 1212 and 18 U.S.C. 1001, the filing of a false, fictitious, or fraudulent document with the Bureau of Land Management may result in a fine of up to \$10,000, a prison term not to exceed five years, or both.

LENOY D. WILSON
(Owner's Name - Please Print)

P.O. BOX 125
(Street or P.O. Box)

Lenoy D. Wilson
(Owner's Signature)

FAIRVIEW UTAH 84629
(City) (State) (Zip Code)

JACK CRUKSHANK
(Owner's Name - Please Print)

P.O. BOX 5071
(Street or P.O. Box)

Jack Crukshank
(Owner's Signature)

QUARTZSITE AZ 85359
(City) (State) (Zip Code)

(Owner's Name - Please Print)

(Street or P.O. Box)

(Owner's Signature)

(City) (State) (Zip Code)

(Owner's Name - Please Print)

(Street or P.O. Box)

(Owner's Signature)

(City) (State) (Zip Code)

(Continued on reverse)

ENTERED INTO COMPUTER

DM 9/14/00

VERIFIED
for 10/23/00

(Owner's Name - Please Print)	(Owner's Signature)		
(Street or P.O. Box)	(City)	(State)	(Zip Code)
(Owner's Name - Please Print)	(Owner's Signature)		
(Street or P.O. Box)	(City)	(State)	(Zip Code)
(Owner's Name - Please Print)	(Owner's Signature)		
(Street or P.O. Box)	(City)	(State)	(Zip Code)
(Owner's Name - Please Print)	(Owner's Signature)		
(Street or P.O. Box)	(City)	(State)	(Zip Code)

INSTRUCTIONS

1. This certification of waiver from payment of maintenance fees is made under the provisions of the Act of August 10, 1993 (107 Stat. 312 [1993]), and §1744 of Title 43 and §28-28k of Title 30 of the United States Code; and the regulations thereunder (43 CFR 3833 and 3850).
2. This waiver must be filed in advance of the assessment year for which a waiver is sought, but in no event be filed later than the August 31st preceding the assessment year for which the waiver is sought.
3. You must still record your affidavit of assessment work for claims listed and/or Notices of Intention to Hold for any sites listed with the BLM by each December 30th, and the local recording office under State law, as in the past.
4. This waiver must be filed in the BLM State Office where the mining claims are recorded.
5. If the claims and sites are located in more than one State, a separate waiver form must be filed in each State in which they are held. The total number of claims and sites listed on separate waiver forms cannot exceed ten.
6. All claim names and Bureau of Land Management (BLM) serial numbers must be listed for all mining claims and sites for which a waiver is sought.
7. All owners and their addresses must be listed.
8. This waiver form must be signed by all of the owners or their designated agent. If an agent is designated, a statement appointing the agent, must be submitted with this certification, if a designation of agent is not currently on file with the BLM State office where your claims and sites are recorded.
9. Mining claims and sites held by a husband and wife, either jointly or individually, or their children under the age of discretion, shall be counted towards the 10 claim limit. Mining claims and sites held in co-ownership, or by an association of locators, by a partnership, or by a corporation shall be counted towards the 10 claim limit for claimants that have an interest in these entities.
10. Failure to pay the maintenance fee or meet the requirements for waiver from payment of the maintenance fee by any August 31st deadline for the following assessment year shall cause the mining claims and sites to be declared null and void.

NOTICE

The Privacy Act of 1974 and the regulation in 43 CFR 2.48(d) provide that you be furnished the following information in connection with the information required by this certification of exemption from rental fees form.

AUTHORITY: 30 U.S.C. 28-28e; 43 U.S.C. 1201, 1740, and 1744; and the Act of August 10, 1993 (107 Stat. 312); 43 CFR 3833 and 3850.

PRINCIPLE PURPOSE: This information is to be used to verify that the owner(s) of a mining claim has complied with the Act of August 10, 1993 (107 Stat. 312), and is entitled to perform assessment work in lieu of paying the maintenance fee for the mining claims listed on this form.

ROUTINE USE: (1) Adjudication of the claimant(s) certification of waiver from paying the maintenance fee otherwise required by the Act of August 10, 1993 (107 Stat. 312). (2) Disclosure may be made to appropriate Federal agencies when location is made within the agency's geographic area of responsibility. (3) Information from the record and/or the record will be transferred to the appropriate Federal, State, or local agency, or a member of the public in response to a specific request for pertinent information. (4) Information may also be provided to the

Department of Justice or in a proceeding before a court or adjudicative body; or to Federal, State, local or foreign agencies when needed for enforcement of civil or criminal codes or applicable regulations concerning title rights upon the public land.

EFFECT OF NOT PROVIDING INFORMATION: Disclosure of this information is required by the Act of August 10, 1993 (107 Stat. 312) and 43 CFR 3833 for those owner(s) wishing to take the small miners waiver allowed under 43 CFR 3833 and 3850. Failure to supply the information required in this form to support the owner(s) certification of waiver from payment of the otherwise required maintenance fees will result in the waiver being disallowed and the mining claims declared null and void by the Bureau of Land Management (BLM).

The Paperwork Reduction Act of 1980 (44 U.S.C. 3501, et seq.) requires us to tell you that:

This information is being collected to allow the BLM to determine if you qualify for a waiver from the payment of \$100 per mining claim maintenance fee established by the Act of August 10, 1993 (107 Stat. 312) and the implementing regulations at 43 CFR 3833 and 3850. A response to this request is required in accordance with the statute (107 Stat. 312) to retain your benefit.

BURDEN HOURS STATEMENT

Public reporting burden for this form is estimated to average 5 minutes per response, including time to review instructions, gathering and maintaining data, and completing and reviewing the form. Direct comments regarding this burden estimate, or any other aspect of this form, to the Department of the Interior, Bureau of Land Management, Information Collection Clearance Officer (871), 1849 C Street, N.W., Washington, D.C. 20240; and the Office of Management and Budget, Paperwork Reduction Project (1004-0114), Washington, D.C. 20503.

FOR OFFICIAL USE ONLY

RECEIVED
 BUREAU OF
 LAND MANAGEMENT

Aug 31 12 05 PM '00

PHOENIX, ARIZONA

MAINTENANCE FEE PAYMENT

\$100.00 MAINTENANCE FEE PAYMENT DUE ON OR BEFORE AUGUST 31, 1999
 IN LIEU OF ASSESSMENT WORK FOR THE UPCOMING ASSESSMENT
 YEAR BEGINNING SEPTEMBER 1 OF THE YEAR NOTED ABOVE.

Bureau Of Land Management
 Arizona State Office
 222 North Central Avenue
 Phoenix, AZ. 85004-2203

<u>349578</u>	<u>350437</u>	<u>352009</u>
		<u>350201</u>
<u>330410</u>	<u>349346</u>	<u>350296</u>
COUNT: <u>60</u> \$ <u>6000.</u> INT: <u>KC</u>		
FOR OFFICIAL USE ONLY		

THE CLAIMS ARE SITUATED IN MARICOPA COUNTY, ARIZONA.

BLM SERIAL NUMBERS	NAMES OF CLAIMS OR SITES
A MC <u>349578</u> THRU A MC <u>349620</u>	<small>#4-5-6-91-92-93-94-95-96-97-98-99-100-101-102-103-104-105 106-107-108-109-110-111-112-113-114-115-116-117-118-119-120-121-122 123-124-125-126-127-128-129-130</small>
COUNTY BOOK/DOCKET _____, PAGE(S) OR FEE NO(S) _____	
A MC <u>352009</u> THRU A MC <u>352015</u>	<small>#9 #12 #19 #54 #55 #56 #57</small>
COUNTY BOOK/DOCKET _____, PAGE(S) OR FEE NO(S) _____	

(OR) IF NOT CONSECUTIVE NUMBERS LIST SEPARATELY BELOW:

BLM SERIAL NUMBERS	NAME OF CLAIMS/SITES	COUNTY BOOK/DOCKET & PAGE OR FEE NUMBER
A MC <u>330410</u>	<u>Rocking Horse # 1</u>	_____
A MC <u>349346</u>	<u>Rocking Horse # 7</u>	_____
A MC <u>349347</u>	<u>Rocking Horse # 80</u>	_____
A MC <u>349348</u>	<u>Rocking Horse # 88</u>	_____
A MC <u>350296</u>	<u>Rocking Horse # 14</u>	_____
A MC <u>350297</u>	<u>Rocking Horse # 39</u>	_____
A MC <u>350298</u>	<u>Rocking Horse # 53</u>	_____
A MC <u>350201</u>	<u>Rocking Horse # 17</u>	_____
A MC <u>350202</u>	<u>Rocking Horse # 18</u>	_____
A MC <u>350439</u>	<u>KNS # 4</u>	_____

CLAIMANT'S NAME: THOMAS J. SMALL

ADDRESS: 361 E. KANIKSU ST CITY: APACHE JUNCTION STATE: AZ.

CHECK HERE IF THIS IS A CHANGE OF ADDRESS PHONE: (480) 671-1053

SIGNATURE: Thomas J. Small
 TO RECORD WITH THE COUNTY, ONE CLAIMANT OR THE AGENT MUST SIGN

RECEIVED
 BLM STATE OFFICE
 AUG 23 1999
 214818

LIST ALL ADDITIONAL OWNERS ON REVERSE SIDE OF THIS FORM
 FOR OFFICIAL USE ONLY **VERIFIED ENTERED INTO COMPUTER**
TL 10-85-99 8-30-99

33.0-5(e) (August 30, 1994) REQUIRES THAT THE NAMES OF ALL OF THE OWNERS AND THEIR ADDRESSES SHALL BE IDENTIFIED ON ALL INSTRUMENTS REQUIRED TO BE RECORDED BY THE REGULATIONS, 43 CFR SUBPART 3833.

OWNER'S NAME: _____
ADDRESS: _____ CITY: _____ STATE: _____

CHECK HERE IF THIS CHANGE OF ADDRESS PHONE: () _____ ZIP: _____

OWNER'S NAME: _____
ADDRESS: _____ CITY: _____ STATE: _____

CHECK HERE IF THIS CHANGE OF ADDRESS PHONE: () _____ ZIP: _____

OWNER'S NAME: _____
ADDRESS: _____ CITY: _____ STATE: _____

CHECK HERE IF THIS CHANGE OF ADDRESS PHONE: () _____ ZIP: _____

OWNER'S NAME: _____
ADDRESS: _____ CITY: _____ STATE: _____

CHECK HERE IF THIS CHANGE OF ADDRESS PHONE: () _____ ZIP: _____

OWNER'S NAME: _____
ADDRESS: _____ CITY: _____ STATE: _____

CHECK HERE IF THIS CHANGE OF ADDRESS PHONE: () _____ ZIP: _____

OWNER'S NAME: _____
ADDRESS: _____ CITY: _____ STATE: _____

CHECK HERE IF THIS CHANGE OF ADDRESS PHONE: () _____ ZIP: _____

OWNER'S NAME: _____
ADDRESS: _____ CITY: _____ STATE: _____

CHECK HERE IF THIS CHANGE OF ADDRESS PHONE: () _____ ZIP: _____

POOR QUALITY

The following pages are scanned at the best possible quality setting. The original pages are of poor quality and this is the best possible reproduction.

UNITED STATES
DEPARTMENT OF THE INTERIOR
BUREAU OF LAND MANAGEMENT

RECEIPT AND ACCOUNTING ADVICE

NO. 2296774

Subject: CLAIM MAINTENANCE FEE \$200
QUIT CLAIM DEED APR. 15 1985

Applicant: THOMAS J. BRILL
361 E. KANUKSU ST.
BRANCHED JUNCTION UT 84302

Remitter:

Assignor:

LEASE MANAGEMENT DATA NEW UPDATE PAYMENT

ORIGINAL SERIAL NO.	ASG.	TYPE	ST.	CTY.	FUND SYMBOL	ACRES/UNITS	RATE

AMOUNT	ANV. DATE	EXP. DATE	BILL CYC.	S/C	DISTRICT	NEXT BILL	MISC. DATA	U of M	ACTUAL UNITS

ASSIGNMENT SERIAL NO.	ASG.	TYPE	ST.	CTY.	FUND SYMBOL	ACRES/UNITS	RATE

AMOUNT	ANV. DATE	EXP. DATE	BILL CYC.	S/C	DISTRICT	NEXT BILL	MISC. DATA	U of M	ACTUAL UNITS

APPLY REMITTANCE

ACTION	FUND SYMBOL	CTY.	AMOUNT
FILING FEE			
RENTAL			
UNEARNED			
REFUND			
TOTAL			
AMOUNT DUE			

Remarks:

BY:

DATE:

- Lease in Escrow?
- KGS? Of Interest?
- Auto Escalates? Operating Rights?
- Auto Renew? Operator
- Bond Filed?

FOR MMS USE ONLY

BILLEE		FOREST REFUGE
NUMBER		
OCS SECTION		
CODE		

This instrument was acknowledged before me this 27 day of July 19 98 by Thomas J. Small
In witness whereof I herewith set my hand and official seal.
Ramon Lopez Jr NOTARY PUBLIC

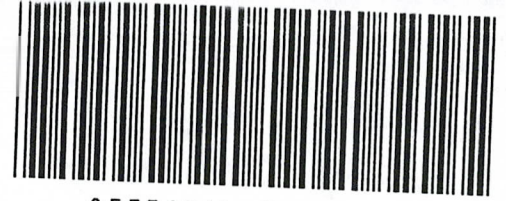
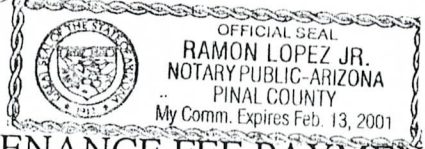

OFFICIAL RECORDS OF
MARICOPA COUNTY RECORDER
HELEN PURCELL
98-0764267 08/28/98 11:25
HESR1 1 OF 1

MAINTENANCE FEE PAYMENT

\$100.00 MAINTENANCE FEE PAYMENT DUE ON OR BEFORE AUGUST 31, 1998
IN LIEU OF ASSESSMENT WORK FOR THE UPCOMING ASSESSMENT
YEAR BEGINNING SEPTEMBER 1 OF THE YEAR NOTED ABOVE.

BUREAU OF LAND MANAGEMENT
ARIZONA STATE OFFICE
222 NORTH CENTRAL AVENUE
PHOENIX, AZ 85004

COUNT: 52 \$ 5200.00 INT: KC FOR
OFFICIAL USE ONLY

THE CLAIMS ARE SITUATED IN MARICOPA COUNTY, ARIZONA.

BLM SERIAL NUMBERS	NAMES OF CLAIMS OR SITES
A MC <u>349578</u> THRU A MC <u>349620</u> COUNTY BOOK/DOCKET _____, PAGE(S) OR FEE NO(S) _____	<u>Rocking Horse #45, 6 ~ 98-0082683-685</u> 43 <u>Rocking Horse #91 thru to and including #130</u> <u>97-0832743-782</u>
A MC <u>349346</u> THRU A MC <u>349348</u> COUNTY BOOK/DOCKET _____, PAGE(S) OR FEE NO(S) _____	<u>Rocking Horse # 1, # 20, # 88</u> 3 <u>98-0000 763-765</u>

(OR) IF NOT CONSECUTIVE NUMBERS LIST SEPARATELY BELOW:

BLM SERIAL NUMBERS	NAME OF CLAIMS/SITES	COUNTY BOOK/DOCKET & PAGE OR FEE NUMBER
A MC <u>350201</u>	<u>Rocking Horse # 17</u>	<u>98-0180989</u>
A MC <u>350202</u>	<u>Rocking Horse # 18</u>	<u>98-0180988</u>
A MC <u>350296</u>	<u>Rocking Horse # 14</u>	<u>98-0503702</u>
A MC <u>350297</u>	<u>Rocking Horse # 39</u>	<u>98-0503703</u>
A MC <u>350298</u>	<u>Rocking Horse # 53</u>	<u>98-0503704</u>
A MC <u>330410</u>	<u>Rocking Horse # 1</u>	<u>94-0341304</u>
A MC _____	_____	_____
A MC _____	_____	_____
A MC _____	_____	_____
A MC _____	_____	_____
A MC _____	_____	_____
A MC _____	_____	_____

RECEIVED
BUREAU OF LAND MANAGEMENT
SEP 8 10 49 AM '98
PHOENIX, ARIZONA

CLAIMANT'S NAME: THOMAS T. SMALL
ADDRESS: 361 E. KARLEIGH ST. CITY: MADEIRA JCT. STATE: AZ ZIP: 85219
 CHECK HERE IF THIS IS A CHANGE OF ADDRESS PHONE: (602) 671-1053

SIGNATURE: Thomas J. Small
TO RECORD WITH THE COUNTY, ONE CLAIMANT OR THE AGENT MUST SIGN

LIST ALL ADDITIONAL OWNERS ON REVERSE SIDE OF THIS FORM
FOR OFFICIAL USE ONLY
ENTERED INTO COMPUTER: 9/9/98 DATE INITIALS LS VERIFIED SB

TIME STAMP
PHOENIX, ARIZONA
1998 AUG 28 A 10:47
RECEIVED
B.L.M. AZ STATE OFFICE

43 CFR 3833.0-5(e) (August 30, 1994) REQUIRES THAT THE NAMES OF ALL OF THE OWNERS AND THEIR CURRENT ADDRESSES SHALL BE IDENTIFIED ON ALL INSTRUMENTS REQUIRED TO BE RECORDED OR FILED BY THE REGULATIONS, 43 CFR SUBPART 3833.

CLAIMANT'S NAME: _____
ADDRESS: _____ CITY: _____ STATE: _____ ZIP: _____
 CHECK HERE IF THIS PHONE: () _____
IS A CHANGE OF ADDRESS

CLAIMANT'S NAME: _____
ADDRESS: _____ CITY: _____ STATE: _____ ZIP: _____
 CHECK HERE IF THIS PHONE: () _____
IS A CHANGE OF ADDRESS

CLAIMANT'S NAME: _____
ADDRESS: _____ CITY: _____ STATE: _____ ZIP: _____
 CHECK HERE IF THIS PHONE: () _____
IS A CHANGE OF ADDRESS

CLAIMANT'S NAME: _____
ADDRESS: _____ CITY: _____ STATE: _____ ZIP: _____
 CHECK HERE IF THIS PHONE: () _____
IS A CHANGE OF ADDRESS

CLAIMANT'S NAME: _____
ADDRESS: _____ CITY: _____ STATE: _____ ZIP: _____
 CHECK HERE IF THIS PHONE: () _____
IS A CHANGE OF ADDRESS

CLAIMANT'S NAME: _____
ADDRESS: _____ CITY: _____ STATE: _____ ZIP: _____
 CHECK HERE IF THIS PHONE: () _____
IS A CHANGE OF ADDRESS

CLAIMANT'S NAME: _____
ADDRESS: _____ CITY: _____ STATE: _____ ZIP: _____
 CHECK HERE IF THIS PHONE: () _____
IS A CHANGE OF ADDRESS

CLAIMANT'S NAME: _____
ADDRESS: _____ CITY: _____ STATE: _____ ZIP: _____
 CHECK HERE IF THIS PHONE: () _____
IS A CHANGE OF ADDRESS

POOR QUALITY

The following pages are scanned at the best possible quality setting. The original pages are of poor quality and this is the best possible reproduction.

UNITED STATES
DEPARTMENT OF THE INTERIOR
BUREAU OF LAND MANAGEMENT

RECEIPT AND ACCOUNTING ADVICE

No. 2389302 04

Subject:

CLAIM MAINTENANCE FEE 1996 - 92

TU/AZ

08/28/98

Applicant:

THOMAS SMALL
361 E WARIKHO ST
APACHE JUNCTION AZ 85219

2 13 17

\$,200.00 ✓

Remitter: CK 01862
602 571-1059

Assignor:

SERIAL NO.
ARC 2389302, ET AL.

REFER TO THE ABOVE CASE SERIAL NUMBER IN ALL CORRESPONDENCE. PLEASE INFORM THIS OFFICE OF ANY CHANGE IN ADDRESS.

NOTE: This notice is a receipt for monies paid the United States. If these monies are for required fees in connection with your application to lease, purchase, enter, or otherwise acquire an interest in public lands or resources, this receipt is not an authorization to utilize the land applied for and it does not convey any right, title, or interest in the land for which application is made.

STATE OF ARIZONA
BUREAU OF LAND MANAGEMENT
RECEIVED
SEP 8 10 49 AM '98

This instrument was acknowledged before me this 27 day of Aug 19 98 by Thomas J Small
In witness whereof I herewith set my hand and official seal.
Ramon Lopez Jr NOTARY PUBLIC

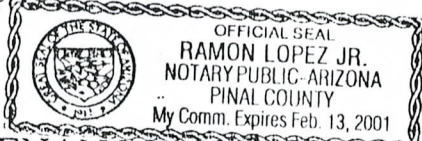

349578 -
349 346 -
350 201 -
350 296 -
330410 -

MAINTENANCE FEE PAYMENT

\$100.00 MAINTENANCE FEE PAYMENT DUE ON OR BEFORE AUGUST 31, 1998
IN LIEU OF ASSESSMENT WORK FOR THE UPCOMING ASSESSMENT
YEAR BEGINNING SEPTEMBER 1 OF THE YEAR NOTED ABOVE.

BUREAU OF LAND MANAGEMENT
ARIZONA STATE OFFICE
222 NORTH CENTRAL AVENUE
PHOENIX, AZ 85004

COUNT: 52 \$ 5200. INT: KC FOR
OFFICIAL USE ONLY

THE CLAIMS ARE SITUATED IN MARICOPA COUNTY, ARIZONA.

BLM SERIAL NUMBERS

NAMES OF CLAIMS OR SITES

A MC 349578 THRU A MC 349620 Rocking Horse #4,5,6 ~ 98-0082683-685 43
COUNTY BOOK/DOCKET _____, PAGE(S) OR FEE NO(S) _____ Rocking Horse # 91 THRU TO AND INCLUDING # 130
97-0832743-782
A MC 349346 THRU A MC 349348 Rocking Horse # 7, # 80, # 88 3
COUNTY BOOK/DOCKET _____, PAGE(S) OR FEE NO(S) _____ 98 0000 763-765

(OR) IF NOT CONSECUTIVE NUMBERS LIST SEPARATELY BELOW:

BLM SERIAL NUMBERS	NAME OF CLAIMS/SITES	COUNTY BOOK/DOCKET & PAGE OR FEE NUMBER
A MC <u>350201</u>	<u>Rocking Horse # 17</u>	<u>98-0180989</u>
A MC <u>350202</u>	<u>Rocking Horse # 18</u>	<u>98-0180988</u>
A MC <u>350296</u>	<u>Rocking Horse # 14</u>	<u>98-0503702</u>
A MC <u>350297</u>	<u>Rocking Horse # 39</u>	<u>98-0503703</u>
A MC <u>350298</u>	<u>Rocking Horse # 53</u>	<u>98-0503704</u>
A MC <u>330410</u>	<u>Rocking Horse # 1</u>	<u>94-0341304</u>
A MC _____	_____	_____
A MC _____	_____	_____
A MC _____	_____	_____
A MC _____	_____	_____
A MC _____	_____	_____
A MC _____	_____	_____

CLAIMANT'S NAME: THOMAS J. SMALL
ADDRESS: 361 E. KAWIKSU ST. CITY: APACHE JCT. STATE: AZ ZIP: 85219
 CHECK HERE IF THIS PHONE: (602) 671-1053 IS A CHANGE OF ADDRESS

SIGNATURE: Thomas J Small
TO RECORD WITH THE COUNTY, ONE CLAIMANT OR THE AGENT MUST SIGN

LIST ALL ADDITIONAL OWNERS ON REVERSE SIDE OF THIS FORM

FOR OFFICIAL USE ONLY
ENTERED INTO COMPUTER: _____
DATE _____ INITIALS _____ VERIFIED _____

TIME STAMP
PHOENIX, ARIZONA
1998 AUG 28 A 10:47
RECEIVED
B.L.M. AZ STATE OFFICE

Form 1370-41
(March 1984)

UNITED STATES
DEPARTMENT OF THE INTERIOR
BUREAU OF LAND MANAGEMENT

RECEIPT AND ACCOUNTING ADVICE

No. 2389802 04

TC/AZ 08/28/98

Subject: CLAIM MAINTENANCE FEE 1999 - 52 2 13 13 5,200.00 ✓

Applicant:
THOMAS SHALL
361 E KARIBU ST
APACHE JUNCTION AZ 85219

CR 01862
Remitter: 602 671-1050

Assignor:

LEASE MANAGEMENT DATA NEW UPDATE PAYMENT

ORIGINAL SERIAL NO.	ASG.	TYPE	ST.	CTY.	FUND SYMBOL	ACRES/UNITS	RATE
ABC 350201, ET AL							

AMOUNT	ANV. DATE	EXP. DATE	BILL CYC.	S/C	DISTRICT	NEXT BILL	MISC. DATA	U of M	ACTUAL UNITS

ASSIGNMENT SERIAL NO.	ASG.	TYPE	ST.	CTY.	FUND SYMBOL	ACRES/UNITS	RATE

AMOUNT	ANV. DATE	EXP. DATE	BILL CYC.	S/C	DISTRICT	NEXT BILL	MISC. DATA	U of M	ACTUAL UNITS

APPLY REMITTANCE

ACTION	FUND SYMBOL	CTY.	AMOUNT
FILING FEE			
RENTAL			
UNEARNED			
REFUND			
TOTAL			
AMOUNT DUE			

Remarks:

BY: _____ DATE: _____

- Lease in Escrow?
- KGS? Of Interest?
- Auto Escalates? Operating Rights?
- Auto Renew? Operator
- Bond Filed?

FOR MMS USE ONLY

BILLEE NUMBER	FOREST REFUGE
OCS SECTION	
CODE	

NOTICE!!

These documents have been scanned!

Do not place un-scanned documents beneath this notice!

Do not remove this notice from this file!

GPO Jacket No. 560-102
Print Order 61540
Rise Business Services, LLC
Job=AZ15 7/3/2019



Box Number= AZ15143



Claim Begin-End: AMC350201-AMC350202

5 Miscellaneous



AZ15143-1

AMC350775-AMC351108

5/06/98

SERIAL NO: AMC350201 CLAIM NAME: ROCKING HORSE #17 CASE TYPE: 384101

SMALL THOMAS J 361 E KANIKSU ST APACHE JUNCTION, AZ 85219
OWNER

2 N 8 E GILA-SALT R. 033 SW SE MARICOPA AZ
DISTRICT PHOENIX FIE

FEB 11,1998	403	LOCATION DATE	
MAY 04,1998	395	RECORDATION DATE	
MAY 04,1998	482	RENTAL/MAINTENANCE FEE	1998
MAY 04,1998	501	ACCT ADV IN LEAD FILE	AMC350201-AMC350202
MAR 09,1998	404	COUNTY RECORDATION	980180989

5/06/98

SERIAL NO: AMC350202 CLAIM NAME: ROCKING HORSE #18 CASE TYPE: 384101

SMALL THOMAS J 361 E KANIKSU ST APACHE JUNCTION, AZ 85219
OWNER

2 N 8 E GILA-SALT R. 033 NE NW SW SE MARICOPA AZ
DISTRICT PHOENIX FIE

FEB 11,1998	403	LOCATION DATE	
MAY 04,1998	395	RECORDATION DATE	
MAY 04,1998	482	RENTAL/MAINTENANCE FEE	1998
MAY 04,1998	501	ACCT ADV IN LEAD FILE	AMC350201
MAR 09,1998	404	COUNTY RECORDATION	980180988

NOTICE!!

These documents have been scanned!

Do not place un-scanned documents beneath this notice!

Do not remove this notice from this file!

GPO Jacket No. 560-102
Print Order 61540
Rise Business Services, LLC
Job=AZ15 7/3/2019



Box Number= AZ15143



Claim Begin-End: AMC350201-AMC350202

6 Location Notices-Amendments and Supporting Documents



AZ15143-1 AMC350775-AMC351108

7/29/98
AM

MINING CLAIM STATUS REPORT

Lead Serial No. A MC 350201 THROUGH A MC 350202

No. of Lode Claims 2

STATUS CHECKED BY [Signature]
Enter Action Code 669

No. of Placer Claims _____

No. of Association Placer
(Not Enough Locators Send Form Ltr.) _____

MTP CHECKED [Signature]
(Reduced Size Copy Enclosed)

No. of Mill Sites _____

ORCA GEO CHECKED [Signature]
(Copy Enclosed)

No. of Tunnel Sites _____

Timely Filed YES NO

WILDERNESS (WA) AREA CHECKED _____

Service Charge Correct YES NO
(This is Curable)

WHICH WA N/A

Location Fee Correct YES NO

Maintenance Fee Correct YES NO

Amount Paid \$ 270.00

Shortage \$ _____ Overage \$ _____

Over-the-Counter Mail

Township(s) T2N

Range(s) R8E

Section(s) 33

GENERAL JURISDICTION OF: BLM (or) WHICH NATIONAL FOREST

Enter Code 880 On Split Estate Land (Show Type of Patent - SX, PX, SRHE etc)

Enter Code 267 For Stockraising Homestead When Proper Notice Has Been Filed

STATUS.

CLAIMS PARTIALLY VOID: Private Minerals _____ Withdrawn _____ Other _____

CLAIMS VOID: Private Minerals _____ Withdrawn _____ Other _____

ADD: DATE RECEIVED, ACTION CODE 482, IN REMARKS: 1995, 1996, 1997, 1998

SPECIAL INSTRUCTIONS FOR DATA INPUT: _____

COMMENTS _____

When recorded, mail to:

Name: THOMAS T. SMALL

Address: 361 E. KANIKSU ST.

City/State/Zip Code: APACHE JCT.

ARIZONA 85219

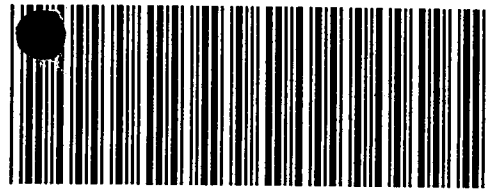

OFFICIAL RECORDS OF
MARICOPA COUNTY RECORDER
HELEN PURCELL

98-0180989 03/09/98 02:28

HESA2 2 OF 2

Space above this line for Recorder's use

NOTICE OF MINING CLAIM

1. TYPE OF NOTICE: Location Amendment Relocation

2. TYPE OF CLAIM: Placer Lode Millsite Tunnelsite

3. The name and address of the Locator is

Name: THOMAS T. SMALL

Address: 361 E. KANIKSU ST.

City/State/Zip Code: APACHE JUNCTION ARIZONA 85219

4. The name of the claim is ROCKING HORSE # 17

5. The date of the location is 2-11-98

6. The claim is 1500' feet long and 600' feet wide. The distance from the location monument to each end of the claim is 10' feet in a EAST direction and 1490' feet in a WEST direction.

7. The general course of the claim is from the EAST to the WEST

8. The location of the claim is in Section 33, Township T-2N, Range 8E

GILA RIVER Base and Meridian, APACHE JCT. QUADRANGLE Mining District, MARICOPA County, State of ARIZONA

9. If amending or relocating, the previous claim name was _____ recorded in Docket(Book) _____ page(s) _____

_____ Mining District, _____ County, State of _____

10. The location of the claim with reference to a natural object or permanent monument is _____

900' OF THE CLAIM IS IN THE NORTHWEST 1/4 OF THE SOUTHWEST 1/4 OF SECTION 33 AND 600' OF THE CLAIM IS IN THE NORTHEAST 1/4 OF THE SOUTHWEST 1/4 OF SECTION 33. IT IS 2100' TO THE EAST OF SECTION'S 32+33 DIVIDING BOUNDARY LINE AND 1800' NORTH OF THE FOREST BOUNDARY LINE.

Dated: 3-9-98

Thomas T. Small
Signature

361 E. KANIKSU ST.
Address

APACHE JCT. AZ. 85219
City/State/Zip

STATE OF ARIZONA }
COUNTY OF MARICOPA } ss.

This instrument was acknowledged before me this 9th day of MARCH, 1998, by Thomas T. Small

In witness whereof I herewith set my hand and official seal.

Valerie [Signature] NOTARY PUBLIC

A MC 890201

RECEIVED
STATE OFFICE
1998 MAY 14 A 10:45
PHOENIX, ARIZONA

MAP OF MINING CLAIM LOCATION

1. The name of the claim is ROCKING HORSE # 17
2. The SOUTH WEST corner of the claim is 2100' feet in a EAST direction ^{FROM} to a survey monument or permanent natural object described as SECTIONS 32+33 FEDERAL SURVEY MONUMENT DIVIDING LINE
3. The type of location monument is 2" x 2" x 8' WOOD POST 4" x 4" WHITE TOP BAND
The type of corner end monuments are 2" x 2" WOOD POST 4" x 4" WHITE TOP BAND
4. The bearing and distance between the corners of the claim are beginning at the SOUTHEAST corner of the claim, 600' feet in a NORTH direction to the NORTHEAST corner, then 1500' feet in a WEST direction to the NORTHWEST corner, then 600' feet in a SOUTH direction to the SOUTHWEST corner, then 1500' feet in a EAST direction to the point of beginning.

MAP

One Inch = One thousand feet

North Arrow



ONE MILE

HC 350201

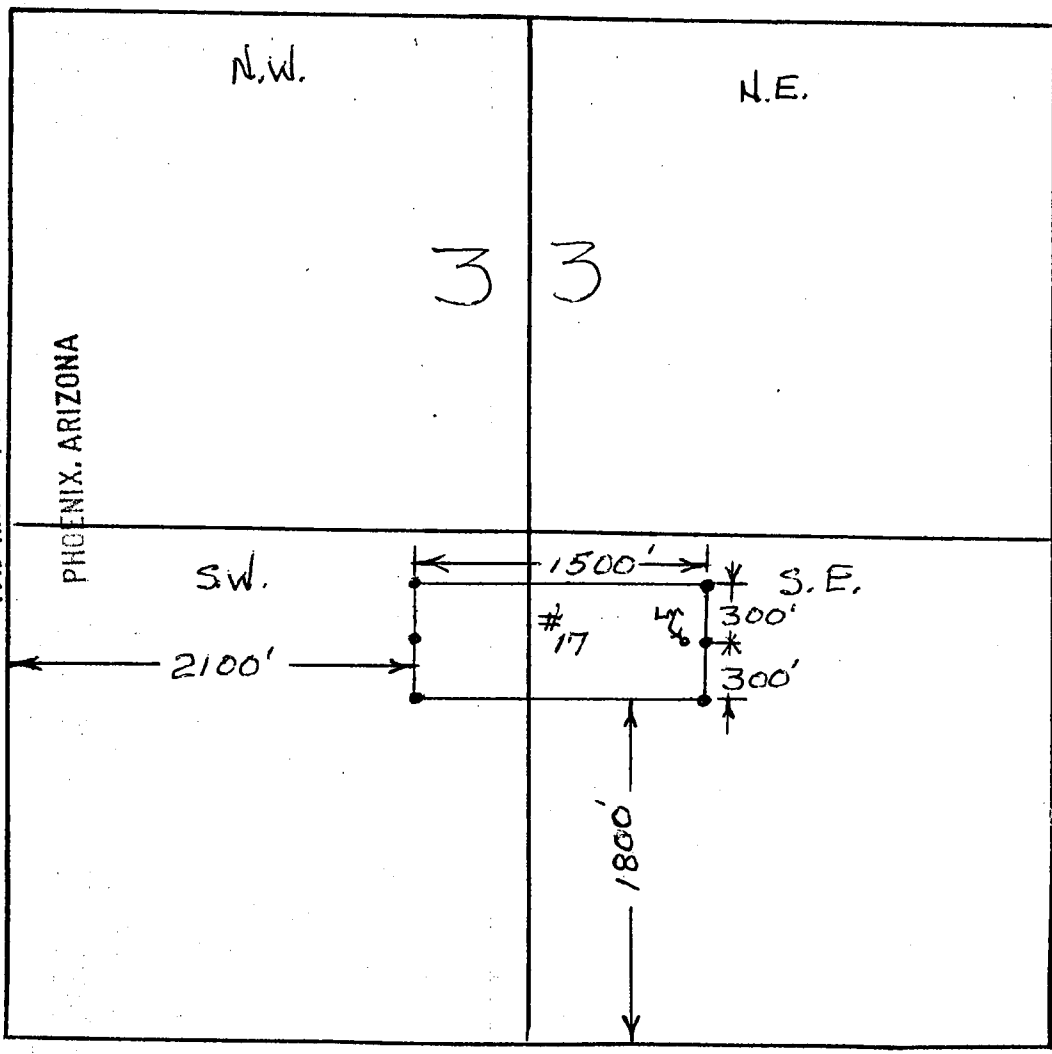

RECEIVED
B.L.M. AZ STATE OFFICE

1998 MAR 14 A 10:46

PHOENIX, ARIZONA

COUNTY OF MARICOPA }
VERMONT ADDRESS }
This instrument was acknowledged before me this 9th day of March, 1998, by Thomas Small in witness whereof I herewith set my hand and official seal.
Thomas Small NOTARY PUBLIC
My Commission Expires June 30, 1998

Section 33 Range 8E Township 2TH
GILA RIVER APACHE CO. QUADRANGLE Base and Meridian.

Dated: 3-9-98 Thomas Small
Signature

When recorded, mail to:

Name: THOMAS T. SMALL

Address: 361 E. KANIKSU ST.

City/State/Zip Code: APACHE JCT.

ARIZONA 85219

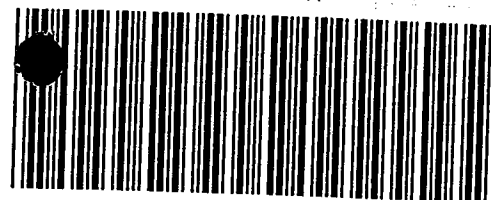

OFFICIAL RECORDS OF
MARICOPA COUNTY RECORDER
HELEN PURCELL

98-0180988 03/09/98 02:28

HESAR 1 OF 2

Space above this line for Recorder's use

NOTICE OF MINING CLAIM

A MC 350202

- 1. TYPE OF NOTICE: Location Amendment Relocation
- 2. TYPE OF CLAIM: Placer Lode Millsite Tunnelsite
- 3. The name and address of the Locator is
 Name: THOMAS T. SMALL
 Address: 361 E. KANIKSU ST.
 City/State/Zip Code: APACHE JUNCTION ARIZONA 85219
- 4. The name of the claim is ROCKING HORSE # 18
- 5. The date of the location is 2-11-98
- 6. The claim is 1500' feet long and 600' feet wide. The distance from the location monument to each end of the claim is 10' feet in a EAST direction and 1490' feet in a WEST direction.
- 7. The general course of the claim is from the EAST to the WEST
- 8. The location of the claim is in Section 33, Township T-2N, Range 8E, GILA RIVER Base and Meridian, APACHE JCT. QUADRANGLE Mining District, MARICOPA County, State of ARIZONA
- 9. If amending or relocating, the previous claim name was _____ recorded in Docket(Book) _____ page(s) _____ Mining District, _____ County, State of _____
- 10. The location of the claim with reference to a natural object or permanent monument is
900' OF THE CLAIM IS IN THE SOUTHWEST 1/4 OF THE NORTHEAST 1/4 OF SECTION 33
900' OF THE CLAIM IS ALSO IN THE NORTHWEST 1/4 OF THE SOUTHWEST 1/4 OF SEC. 33
600' OF THE CLAIM IS IN THE SOUTHWEST 1/4 OF THE NORTHWEST 1/4 OF SECTION 33
600' OF THE CLAIM IS IN THE NORTHEAST 1/4 OF THE SOUTHWEST 1/4 OF SEC. 33. CLAIM IS 2100'
TO THE EAST OF THE BOUNDARY DIVIDING LINE OF SEC. 32+33. CLAIM IS 2400' NORTH OF FOREST
BOUNDARY LINE.

RECEIVED
B.L.M. AZ STAGE OFFICE
PHOENIX, ARIZONA
1998 MAY -11 A 10:14

Dated: 3-9-98

Thomas T. Small
Signature
361 E. KANIKSU ST.
Address
APACHE JCT. AZ 85219
City/State/Zip

STATE OF ARIZONA }
COUNTY OF MARICOPA }

This instrument was acknowledged before me this 9th day of March, 1998, by Thomas Small

© 1991, by the Arizona State Board of Registration of Professional Surveyors, ARIZONA 85732-3881

Helen Purcell
NOTARY PUBLIC

MAP OF MINING CLAIM LOCATION

- The name of the claim is DEKING HORSE # 18
- The SOUTHWEST corner of the claim is 2100' feet in a EAST direction ^{from} to a survey monument or permanent natural object described as SECTIONS 32+33 FEDERAL SURVEY MONUMENT DIVIDING LINE
- The type of location monument is 2" x 2" WOOD POST 4" x 4" WHITE TOP BAND
The type of corner end monuments are 2" x 2" WOOD POST 4" x 4" WHITE TOP BAND.
- The bearing and distance between the corners of the claim are beginning at the SOUTHEAST corner of the claim, 600' feet in a NORTH direction to the NORTHEAST corner, then 1500' feet in a WEST direction to the NORTHWEST corner, then 600' feet in a SOUTH direction to the SOUTHWEST corner, then 1500' feet in a EAST direction to the point of beginning.

MAP

One inch = One thousand feet

North Arrow



ONE MILE

RECEIVED
B.L.M. AZ STATE OFFICE

ONE MILE - 4 A 10:46

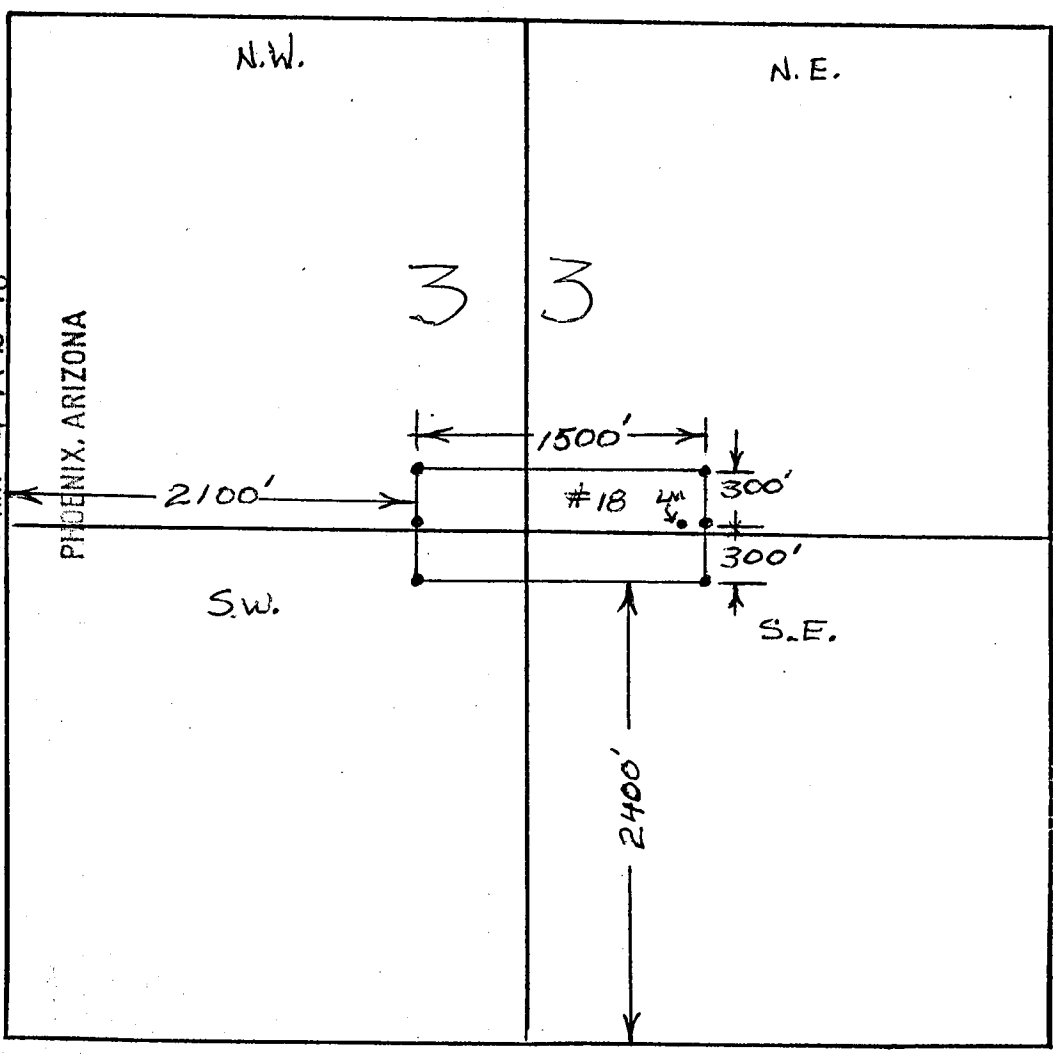

STATE OF ARIZONA }
COUNTY OF MARICOPA } ss.
This instrument was acknowledged before me this 9th day of MARCH, 1998, by Thomas Small in witness whereof I herewith set my hand and official seal.
Thomas Small
NOTARY PUBLIC
My Commission Expires June 30, 1998

Section 33 Range 8E Township T-2N
GILA RIVER APACHE JUNCTION QUADRANGLE Base and Meridian.
Dated: 3-9-98 Thomas Small
Signature

HC 350202

*** U.S. DEPARTMENT OF THE INTERIOR *** BUREAU OF LAND MANAGEMENT *** ORCA
*** GEOGRAPHIC CROSS REFERENCE *** 05/06/98 ***

GEOGRAPHIC STATE: ARIZONA MERIDIAN: 14 TOWNSHIP: 2-0N RANGE:
8-0E

SEC SUBDIVISION MTR X-REFERENCE NUMBER/TYPER/DISPOSITION/ACR
ES PROPRIETOR/INTEREST/RELATIONSHIP

1	POR W/IN 1MI OF SALT RIV	14	2-0N	7-0E	CASE: AZA	012958
	BR REGIONAL OFFICE	100.00000%	HOLDING AGENC			
2	POR W/IN 1MI OF SALT RIV	14	2-0N	9-0E	TYPE: 231201	WDL-RECLAMATIO
N						
3	POR W/IN 1MI OF SALT RIV	14	2-0N	10-0E	DISP: AUTHORIZED	03/02/03
4	POR W/IN 1MI OF SALT RIV	14	3-0N	7-0E	ACRS: 63704.820	
5	POR W/IN 1MI OF SALT RIV	14	3-0N	8-0E		
6	POR W/IN 1MI OF SALT RIV	14	3-0N	9-0E		
7	POR W/IN 1MI OF SALT RIV	14	3-0N	10-0E		
8	POR W/IN 1MI OF SALT RIV	14	3-0N	11-0E		
9	POR W/IN 1MI OF SALT RIV					
*19	POR	14	1-0N	8-0E	CASE: AZA	013016
	BR REGIONAL OFFICE	100.00000%	HOLDING AGENC			
*20	POR	14	2-0N	9-0E	TYPE: 231201	WDL-RECLAMATIO
N						
*21	POR	14	2-0N	10-0E	DISP: AUTHORIZED	08/21/09
*22	POR				ACRS: 01538.880	
*23	POR					
*24	POR					
*25	POR					
*26	POR					
*27	POR					
*28	POR					
*29	POR					
*30	POR					
*31	POR					
*32	POR					
*33	POR					
*34	POR					
*35	POR					
*36	POR					

1	3MI S OF SALT RIVER	14	2-0N	7-0E	CASE: AZA	013376
	BR REGIONAL OFFICE	100.00000%	HOLDING AGENC			
		14	2-0N	9-0E	TYPE: 231270	WDL-RECLAMATIO

14 2-ON 10-OE
14 2-ON 11-OE
14 3-ON 7-OE
14 3-ON 8-OE
14 3-ON 9-OE
14 3-ON 10-OE
14 3-ON 11-OE
14 3-ON 12-OE
14 4-ON 11-OE
14 4-ON 12-OE

DISP: CLOSED 06/07/56
ACRS: 08074.060

1 ALL 14 3-ON 8-OE CASE: AZA 019105
FERC 100.00000% HOLDING AGENC
2 ALL 14 4-ON 8-OE TYPE: 234400 WDL-FED ENERGY
REG GENTRY RES CORP 0.00000% APPLICANT
3 ALL DISP: AUTHORIZED 11/10/83
4 ALL ACRS: 00001.000
9 ALL
10 ALL
11 ALL

* = REJECTED/SEGREGATED/ASSIGNED-OUT

CASE TYPE: ALL DISPO: ALL

14 2-ON 8-OE

CASE TYPE: ALL DISPO: ALL

14 2-ON 8-OE

PARTIALLY SURVEYED TOWNSHIP 2 NORTH RANGE 8 EAST OF THE GILA AND SALT RIVER MERIDIAN, ARIZONA

MARICOPA COUNTY

STATUS OF PUBLIC DOMAIN
LAND AND MINERAL TITLES

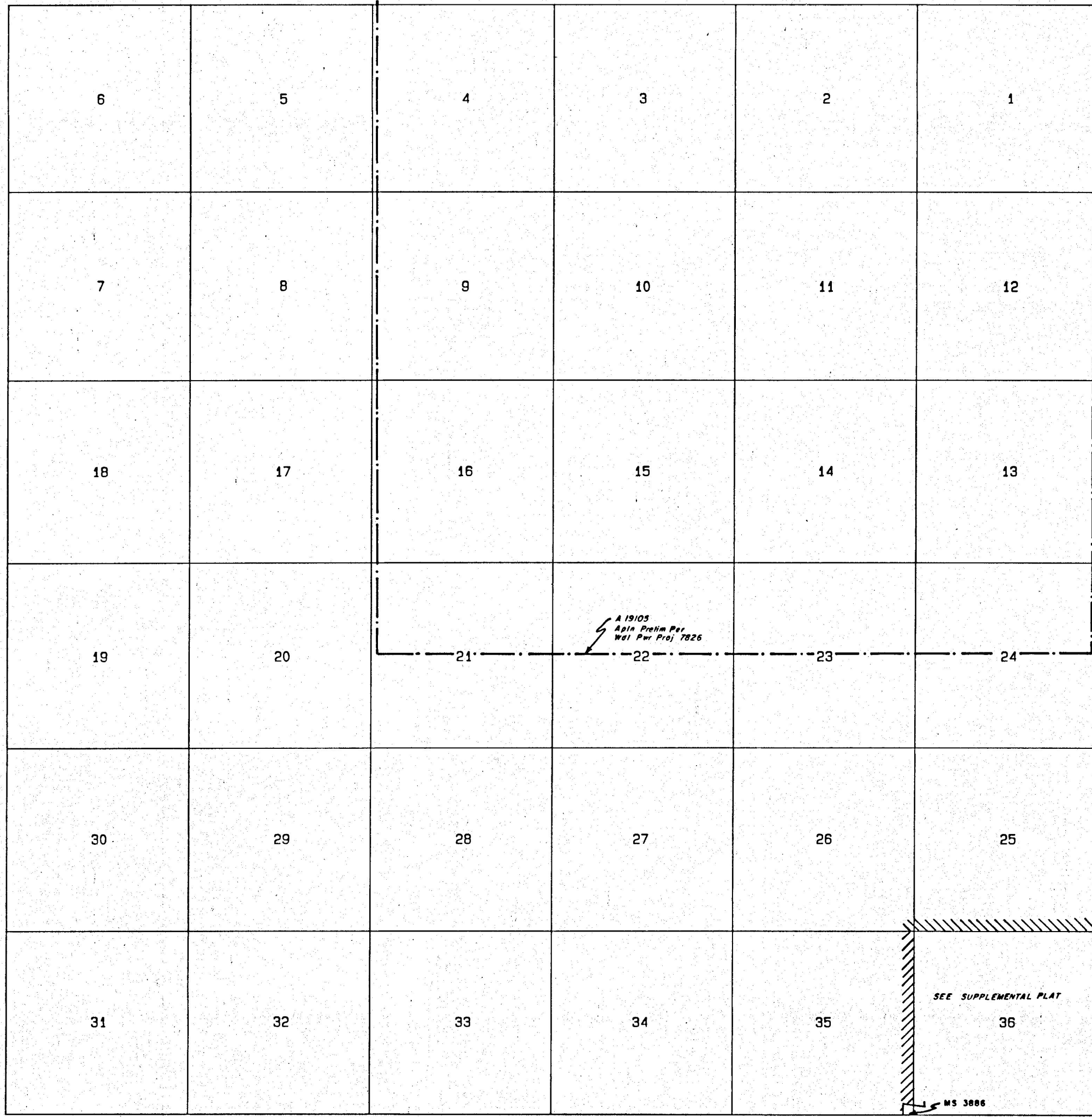

INDEX TO SEGREGATED TRACTS				
RESURVEY		ORIGINAL SURVEY		
TRACT NO	T	R	SEC	SUBDIVISION

FOR ORDERS EFFECTING DISPOSAL OR USE OF UNIDENTIFIED LANDS WITHDRAWN FOR CLASSIFICATION, MINERALS, WATER AND/OR OTHER PUBLIC PURPOSES, REFER TO INDEX OF MISCELLANEOUS DOCUMENTS.

Channel of Salt River from Tonto Creek to Verde River & All land lying within 1 mile thereof included in Temp. Wdl. for Irrigation purposes. SO 3/2/1905

All Tp. included in Wdl. Tonto N. F., Proc. 837 2/10/1909

All land which when sur. will be within legal subdivisions within 1/2 mile of Salt River included in WP Des. 8 (AR-5) SO 2/9/1917

PROTRACTION DIAGRAM NO. 60

ALL INCLUDED IN DETERMINATION AREA 8/20/1957 ARO17614

MDS II B SE

A 2864 Reel Slips

RECEIVED
 BLM AZ STATE OFFICE
 1998 MAY - 6 A P M
 PHOENIX, ARIZONA

CURRENT TO	BY

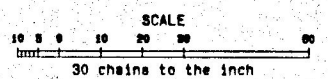

WARNING STATEMENT
 This plat is the Bureau's Record of Title, and should be used only as a graphic display of the township survey data. Records hereon do not reflect title changes which may have been effected by lateral movements of rivers or other bodies of water. Refer to the cadastral surveys for official survey information.

T. 2N
R. 8E